

2014 WE HAVE ALL YOU NEED!

All about you

Create my own style

Our promise to you

Reach your dreams

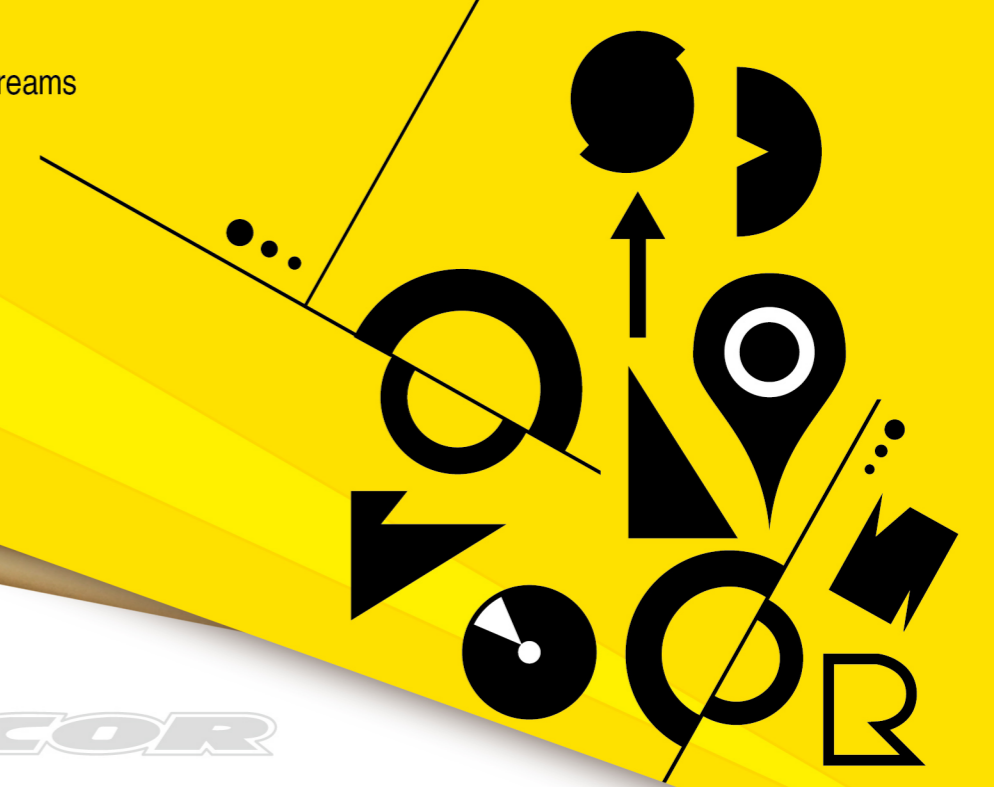
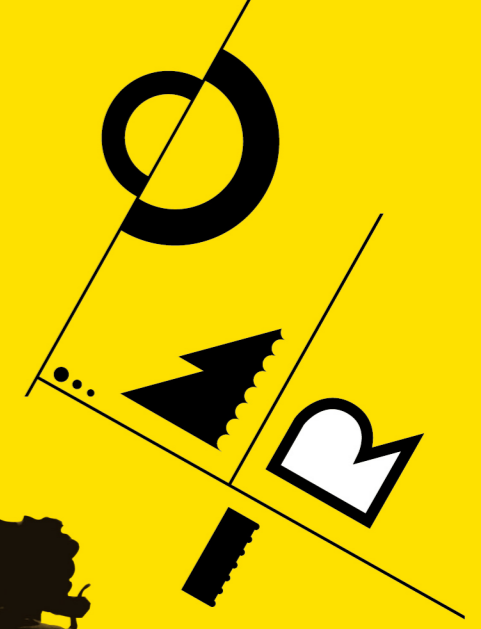

ACOR

18 8th Rd., Taichung Ind. Park, Taichung City, 407 Taiwan.
Tel:+886-4-2359-1201 Fax:+886-4-2359-1562
Website: www.acorsports.com
Email: acor@acorsports.com.tw



ACOR

ACOR – ALL CYCLING OFF/ON ROAD

ACOR, the brand which comes from "Acorn" - a symbol of patience and the achievement of hard work. An English proverb states that Great oaks from little acorns grow, urging the listener to wait for maturation of a project or idea. At ACOR, we are doing and following this spirit.

The industry and markets we serve are dynamic, changes occur rapidly, and product innovations are expected. Our leadership in the industry has been earned by our continuous efforts in research and development. Innovation and improvement is deeply embedded in ACOR.

The core principle upon which ACOR was founded lies within our commitment to develop innovative technologies that will redefine the cycling experience. At ACOR, our primary focus has been and will continue to be fulfilling our dedication to reinvent the bicycle components and accessories through our expertise and know-how in the fields of bicycle manufacturing and material technologies.

ACOR is proud to be recognized internationally for the ingenuity of our manufacturing, product innovation, and our commitment to further technological breakthroughs. ACOR is flexible and able to respond quickly to changing market expectations and demand. Through strong research and development supported by manufacturing technologies and processes, ACOR provides a broad range of bicycle components and accessories of the highest quality to meet market trends. Combining CNC processing with high grade materials, such as aluminum and titanium, we produce products of exceptional quality and extraordinary versatility, all of which meet EN standards.

We offer our customers the perfect balance of functionality, aesthetics and experience. These values are the core of our business. In order to completely understand and incorporate these values into the newest products it is of paramount importance to explore the future.

Nowadays ACOR brand is distributed worldwide in more than 20 countries. We are a company where expertise matters. Our focus in achieving the highest standards in everything we do is a clear reflection of the outstanding products we make. Driven by innovation, excellence and a refusal to conform, we are continuously searching to improve our products. A product symbolizes our evolution.

Any ACOR cyclist is familiar with the beauty of the journey: the wind blowing your hair, your bicycle flying over the road. To enjoy the cycling on/off the road, it is ACOR!



TITANIUM

FRAMES	05
FORKS	08
STEMS/SPACERS	09
BARENDS/ HANDLEBARS	10
SEATPOSTS/CLAMPS	12
HEADSETS /	13
QUICK RELEASES /	
BOTTLE CAGES	
BELLS/PULLEYS/BOLTS	14



BICYCLE PARTS

BARENDS	15
BOTTOM BRACKETS	17
BRAKE LEVERS	18
BRAKES	20
DISC ROTORS	21
BRAKE SHOES	22
CABLES	24
CHAINS	25
GRIPS	27
GRIP TAPES	30
HANDLEBARS	31
HEADSETS	34
HUBS	36
PEDALS	37
SADDLES	43
SADDLE COVERS/SEATPOSTS	47
SEATTUBE CLAMPS	49
QUICK RELEASES	54
STEMS	56
SPACERS/STEM TOP CAPS	59



ACCESSORIES

BAGS	61
BASKETS	65
BELLS	67
BIKE HOLDERS	71
BIKE PROTECTOR/BOTTLE	73
BOTTLE CAGES	75
CARRIERS	80
CHAIN GUIDES	82
COMPUTERS/FENDERS	83
FREEWHEELS/	86
INNER TUBE & ACCESSORIES	
KICKSTANDS	87
LIGHTS	91
LOCKS	96
PROTECTOR	97
PUMPS	100
RD ACCESSORIES	104
SPORT GLASSES	105
SPORTS GLASSES & WARMERS	108
SPORTS HELMETS/	109
SPORTS SHOES	
TOOLS	111
TRAINING WHEELS	119
PROMOTION ITEMS	120

Nothing looks like Titanium, Nothing Rides like Titanium, Titanium will never let you down.

Titanium is phenomenally well suited to bicycle frame construction. Its strength to weight ratio is excellent, its fatigue strength and fracture toughness unparalleled, and it will not corrode under atmospheric conditions. Titanium is tough, but it has a softer side. It has a flexibility that absorbs road vibrations, allowing you to ride in comfort even when pushing hard over rough ground. It will not rust, no matter how bad the weather gets. That's its softer side on display again and again, giving a little when it needs to. No wonder we offer a lifetime guarantee on every frame.

ACORti ADVANTAGES

- ACORti titanium products have a strength-to-weight ratio that is on average 75% greater than most aluminum and steel materials used in cycling
- ACORti titanium products have a fatigue life that is five times greater than that of steel or aluminum. This means that your frame will have a significantly longer life span than other bicycles.
- Every frame we make uses custom drawn tubing that is designed to maximize strength and performance by using differing diameter and thickness of tubing for each size and application.
- ACORti uses precise shape optimized cold worked and stress relieved (CWSR) titanium tube sets to produce our award winning ride for every frame we make.



ACORti – LEADERSHIP THROUGH INNOVATION

ACORti has successfully applied its aerospace manufacturing experience in titanium alloy technology to the production of bicycle components. Our use of custom drawn and cold worked high-quality seamless Ti3AL/2.5V titanium alloy tubes and the use of superb welding workmanship results in high-quality high-performance products. We are also very experienced in making bicycle frames to custom specifications. These frames are based on the customers' needs or rider's biometrics and the characteristics that they require in a bicycle. Not only do these frames excel in quality and performance, but they demonstrate our engineering and manufacturing abilities and flexibility to meet each customer's individual needs.

At ACORti, we take the design, fabrication, and material selection process very seriously, creating the best product possible for the intended application; making bikes go fast and last a long time. These are just a few of the reasons why our frames and components are leading the industry when it comes to innovation and craftsmanship.





T-CC01

T-CC02 with Cantilever brake system

- **Spec:** Ti 3AL2.5V Cyclocross with POST MOUNT Frame
Ti oval D/B TT & P/G DT
P/G seat stays, oval chain stays
1-1/8" to 1.5" Tapered integrated H/T OD 46/56mm
Cable run internally, 2-pc hanger
- **Seatpost:** 27.2mm
- **Option Size:** 51, 53, 55, 57, 59, 61cm
- **Weight:** 1620g / 53cm



T-F001

- **Spec:** Ti 3AL2.5V Fixed Gear Frame
Ti Shaped TT & DT
P/G seat stays, oval chain stays
1-1/8" semi-integrated H/T OD 44/50mm
- **Seatpost:** 27.2mm
- **Option Size:** 50, 52, 54, 56, 58cm
- **Weight:** 1378g / 54cm

T-M002

- **Spec:** Ti 3AL2.5V Mountain Frame
Fully Ti double butted TT & DT
1-1/8" semi-integrated H/T OD 44/50mm
CNC dropout and built with Ti 6AL4V
Compatible with Disc brake
- **Seatpost:** 27.2mm or 31.6mm
- **Option Size:** 15", 17", 19"
- **Weight:** 1304g / 17.5cm for 27.2mm seatpost



T-M003
with P/G 0.8 tubing,
1500g/17" for 27.2mm or 31.6 seatpost



T-M005

- **Spec:** Ti 3AL2.5V Mountain Frame
Fully Ti double butted TT & DT
1-1/8" semi-integrated H/T OD 44/50mm
Compatible with Disc brake
- **Seatpost:** Integrated Seat Post system
34.9mm seat clamp compatible
- **Option Size:** S, M, L, XL
- **Weight:** 1382g



T-M006

- **Spec:** Ti 3AL2.5V Mountain Frame
Fully Ti double butted TT & DT
Seat Stay with flexible design
TT with horizontal oval straight type
DT upper bigger and lower smaller ergonomic design
1-1/8" to 1.5" Tapered integrated H/T OD 50/57mm
Compatible with Disc brake
- **Seatpost:** Integrated Seat Post system
34.9mm seat clamp compatible
- **Option Size:** Customization
- **Weight:** 1818g w/o clamp



T-M007

- **Spec:** Ti 6AL4V Mountain Frame
Fully Ti 6AL4V double butted TT & DT
Ti 3AL2.5V Seat stay and Chain stay
1-1/8" integrated H/T
Compatible with Disc brake
- **Option Size:** 15", 17", 19"
- **Weight:** 1300g / 17"

T-M008

- **Spec:** Ti 3AL2.5V 29" MTB POST MOUNT Frame
Ti pear / plum blossom shaped TT
P/G rear stays
1-1/8" to 1.5" Tapered integrated H/T OD 46/56mm
1-pc CNC dropout for Shimano E-thru System ,
OLD:142/12mm suitable for BB92, RC: 438
Cables run internally is available
- **Seatpost:** 31.6mm
- **Option Size:** 15", 17", 19"
- **Weight:** 1756g / 17"



T-M009

- **Spec:** Ti 3AL2.5V 27.5" MTB POST MOUNT Frame
Ti double butted TT & pear shaped DT
P/G rear stays, oval chain stays
1-1/8" semi-integrated H/T OD 44/50mm
2-pc hanger design
- **Seatpost:** 27.2mm
- **Option Size:** 15", 17", 19"
- **Weight:** 1410g / 17"





T-M010

- **Spec:** Ti 3AL2.5V 26" MTB POST MOUNT Frame
Ti Shaped TT & double butted oval DT
P/G rear stays
1-1/8" to 1.5" Tapered integrated H/T OD 50/57mm
Suitable for BB92
- **Seatpost:** 27.2mm
- **Option Size:** 15", 17", 19"
- **Weight:** 1524g / 17"



T-TT01

- **Spec:** Ti 3AL2.5V Time Trial Frame
Ti P/G TT & DT
P/G rear stays
1-1/8" conventional threadless H/T
- **Seatpost:** Integrated Seatpost
- **Option Size:** 49, 51, 53, 55, 57, 59, 61cm
- **Weight:** 1796g / 49cm (w/ ISP seat clamp)

T-R005

- **Spec:** Ti 3AL2.5V Road Racing Frame
Ti shaped TT & DT
P/G rear stays
1-1/8" conventional threadless H/T
- **Seatpost:** 27.2mm
- **Option Size:** 47, 49, 51, 53, 55, 57, 59, 61cm
- **Weight:** 1418g / 49cm



T-M011 T-M012 for 29ER

- **Spec:** Ti 3AL2.5V 27.5" MTB POST MOUNT Frame
Ti hydroform decurved TT
Tetragon rear stays
1-1/8" to 1.5" Tapered integrated H/T OD 46/56mm
1-pc CNC dropout for Shimano E-thru System
OLD: 142/12mm suitable for BB92, RC: 438
Cable run internally
- **Seatpost:** 31.6mm
- **Option Size:** 15.5", 17.5", 19.5"
- **Weight:** 1850g / 17.5"



T-R003

- **Spec:** Ti 3AL2.5V Road Racing Frame
Ti double butted TT & DT
P/G rear stays
1-1/8" Integrated H/T OD45/ID41.4mm
- **Seatpost:** 27.2mm or 31.6mm
- **Option Size:** 50, 52, 54, 56, 58, 60, 62cm
- **Weight:** 1245g / 52cm for 27.2mm seatpost



T-R006

- **Spec:** Ti 3AL2.5V ISP Road Racing Frame
Ti double butted TT & DT
Seat Stay with flexible design
1-1/8" to 1.5" Tapered integrated H/T OD 50/57mm
- **Seatpost:** Integrated Seatpost
- **Option Size:** 49, 51, 53, 55, 57, 59, 61cm
- **Weight:** 1572g w/o ISP seat clamp



T-FM01

- **Spec:** 26" Fully Ti 3AL2.5V MTB fork
For Integrated headset
1-1/8" steerer tube 280L
Round blades
Fork crown race 50mm
- **Option brake system:** Disc or V-type
- **Option length:** Customization
- **Weight:** 775g / 450mm



T-FM03

- **Spec:** 26" Ti 3AL2.5V with Carbon MTB fork
1-1/8" carbon steerer tube 300L
- **Option brake system:** Disc
- **Option length:** Customization
- **Weight:** 760g / 410mm



T-R007

- **Spec:** Ti 3AL2.5V Road Racing Frame
Ti Double butted TT & Shaped DT
P/G seat stays with curved
1-1/8" to 1.5" Tapered integrated H/T OD 50/57mm
Suitable for BB86
- **Seatpost:** 27.2mm
- **Option Size:** 48, 50, 52, 54, 56, 58, 60cm
- **Weight:** 1476g / 50cm



T-FM02

- **Spec:** 26" Fully Ti 3AL2.5V MTB fork
For N/A headset
1-1/8" steerer tube 280L
Round blades
- **Option brake system:** Disc or V-type
- **Option length:** Customization
- **Weight:** 775g / 450mm



T-FM04

- **Spec:** 26" Fully Ti 3AL2.5V MTB fork
For integrated headset
1-1/8" steerer tube 250L
Fork crown race 45mm
- **Option brake system:** IS/PM Disc or V-type
- **Option length:** Customization
- **Weight:** 666g / 415mm



T-FM05

- **Spec:** Fully Ti 3AL2.5V Fixed Gear fork
For integrated headset
1-1/8" steerer tube 270L
Fork crown race 50mm
Suitable for T-F001 frame
- **Option length:** Customization
- **Weight:** 544g / 367mm



T-FM05

- **Spec:** Ti 3AL2.5V stem
Ahead type ±7°
M5 Stainless bolts
Hollowed 4-bolt Ti 6AL4V end cap
- **Size:** 28.6 x 90, 100, 110, 120, 130 x 25.4mm
- **Weight:** 142g / 100cm

T-FM02 31.8mm T-FM04 26.0mm



T-FM07
Suitable for T-CC02 frame with
Cantilever brake system



T-FM06

- **Spec:** Fully Ti 3AL2.5V Cyclocross fork
For 1-1/8" to 1.5" tapered integrated headset
1-1/8" steerer tube 300L
Fork crown race 56mm
- **Option brake System:** PM Disc Suitable for T-CC01 frame
- **Option length:** Customization
- **Weight:** 700g/387.5mm



T-FM06

- **Spec:** Ti 3AL2.5V stem
Ahead type ± 5°
M5 Stainless bolts
Hollowed 4-bolt Ti 6AL4V end cap
- **Size:** 28.6 x 80, 90, 100, 110, 120 x 25.4 or 31.8mm
- **Weight:** 186g / pc

T-FM06

- **Spec:** Ti 3AL2.5V spacer
- **Size:** 28.6 x 5mm, 10mm, 15mm, 20mm
- **Weight:** 2g, 6g, 8g, 12g

T-BRZ01

- **Spec:** Ti 3AL2.5V barend
Round straight type
M5 Stainless bolts
- **Length:** 65mm (C-C)
- **Weight:** 92g / pr



T-BRZ03

- **Spec:** Ti 3AL2.5V barend
Oval tubing
M5 Stainless bolts
- **Length:** 65mm (C-C)
- **Weight:** 84g / pr



T-BRZ05

- **Spec:** Ti 3AL2.5V barend
Conic straight type
M5 Stainless bolts
- **Length:** 80mm (C-E)
- **Weight:** 84g / pr

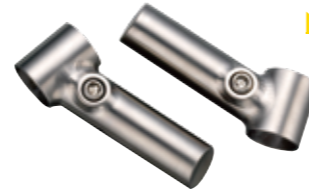

T-BRZ02

- **Spec:** Ti 3AL2.5V barend
Round straight type
M5 Stainless bolts
- **Length:** 90mm (C-C)
- **Weight:** 108g / pr



T-BRZ04

- **Spec:** Ti 3AL2.5V barend
Oval tubing
M5 Stainless bolts
- **Length:** 90mm (C-C)
- **Weight:** 96g / pr



T-BRZ06

- **Spec:** Ti 3AL2.5V barend
Round straight type
With ergonomic design
M5 Stainless bolts
- **Length:** 80mm / 90mm / 100mm (C-C)
- **Weight:** 108g / pr--90mm



T-HB01

- **Spec:** Ti 3AL2.5V handle bar
- **Size:** 580mm / 600mm / 620mm
- **Barbore:** 25.4mm
- **Backsweep:** 5°
- **Rise:** 0°
- **Weight:** 160g--580mm



T-HB02

- **Spec:** Ti 3AL2.5V handle bar
- **Size:** 580mm / 600mm / 620mm
- **Barbore:** 31.8mm
- **Backsweep:** 5°
- **Rise:** 0°
- **Weight:** 200g--580mm



T-HB03

- **Spec:** Ti 3AL2.5V T- bar
- **Size:** 31.8 x 580 / 600 / 620mm x 90 / 100mm x 28.6
- **Weight:** 342g --31.8 x 580mm x 90mm x 28.6



T-HB04

- **Spec:** Ti 3AL2.5V D/B handle bar
- **Size:** 580mm / 600mm
- **Barbore:** 31.8mm
- **Backsweep:** 5°
- **Rise:** 0°
- **Weight :** 150g --580mm



T-HB05

- **Spec:** Ti 3AL2.5V computer expanding bar
- **Size:** Compatible to 31.8mm handle bar
Extension 90mm
- **Weight :** 50g



T-HB06

- **Spec:** Ti 3AL2.5V computer expanding bar
- **Size:** Compatible to 31.8mm handle bar
Extension 60mm
- **Weight :** 40g



T-SEP01

- **Spec:** Ti 3AL2.5V seat post
Top clamp 2-bolt type
AL6061 rail holder
M5 Stainless bolts
- **Offset:** 0 or 20mm
- **Size:** 27.2 / 31.6 x 300 / 350mm
- **Weight:** 232g / 31.6 x 300mm



T-SEP03

- **Spec:** Ti 3AL2.5V 1-pc seat post
1-bolt side-bind design
AL6061 rail holder
M6 Stainless bolts
- **Offset:** 20mm
- **Size:** 27.2 / 31.6 x 350mm
- **Weight:** 272g / 31.6 x 350mm



T-SEP04

- **Spec:** Ti 3AL2.5V 1-pc seat post
Vertical design
AL6061 rail holder
Stainless bolts
- **Size:** 27.2 / 31.6 x 350mm
- **Rail holder Option:** Black, Red, Blue
- **Weight:** 231g / 27.2 x 350mm



T-SEP05

- **Spec:** Ti 3AL2.5V seat post
- **Offset:** 0 mm
- **Size:** 27.2 / 31.6 x 350mm
- **Weight:** 264g / 27.2 x 350mm



T-CLP01

- **Spec:** Ti 6AL4V - straight cut clamp
Slotted design
M5 Stainless bolts
- **Size:** 31.8 / 34.9 x H12mm
- **Weight:** 20g / 31.8mm



T-CLP02

- **Spec:** Ti 6AL4V - aslope cut clamp
M6 Stainless bolts
- **Size:** 31.8 / 34.9 x H12mm
- **Weight:** 22g / 31.8mm



T-CLP03

- **Spec:** Ti 3AL2.5V double clamp
Suitable for carbon frame
Light weight design
M5 Stainless bolts
- **Size:** 27.2 to 31.8 or 31.8 to 34.9 x H20mm
- **Weight:** 30g / 31.8 to 34.9mm



T-CLP04

- **Spec:** Ti 3AL2.5V double clamp
Suitable for carbon frame
M5 Stainless bolts
- **Size:** 27.2 to 31.8 or 31.8 to 34.9 x H25mm
- **Weight:** 34g / 31.8 to 34.9mm



T-CLP05

- **Spec:** Ti 3AL2.5V clamp with QR lever
- **Size:** 31.8 / 34.9 x H21mm
- **Weight:** 44g / 31.8mm



T-HS01

- **Spec:** Ti 6AL4V 11/8" headset
Sealed bearing with Alloy top cap
- **Top cap option:** Silver, Black, Blue, Red, Gold



T-QR01

- **Spec:** Ti 6AL4V axle and lever
AL7075 end nuts
- **Option Length:** F--109 / 112 / 117mm
R--143 / 148 / 155mm
- **Weight:** 68g / pr--F109 / R143mm



T-QR02

- **Spec:** Fully Ti 6AL4V axle and lever
Ti end nuts
- **Option Length:** F--109 / 112 / 117mm
R--143 / 148 / 155mm
- **Weight:** 102g / pr--F109 / R143mm



T-BTG01

- **Spec:** Ti 3AL2.5V plate bottle cage
X-shape design
Flexible for bottle diameter 72-76mm
- **Weight:** 21g



T-BTG02

- **Spec:** Ti 3AL2.5V plate bottle cage
Slim design
Flexible for bottle diameter 72-76mm
- **Weight:** 27g



T-BTG03

- **Spec:** Ti 3AL2.5V plate bottle cage
Slim design with top holder securely
Holds bottle when riding off-road
Flexible for bottle diameter 72-76mm
- **Weight:** 30g



T-BTG04

- **Spec:** Ti 6AL4V plate bottle cage
With pure Ti tubing slim design
Flexible for bottle diameter 72-76mm
- **Weight:** 21g



T-BTG05

- **Spec:** Ti 3AL2.5V plate bottle cage
Welded construction Ø3.0mm
Titanium solid bar
Flexible for bottle diameter 72-76mm
- **Weight:** 27g



T-BE01

- **Spec:** Fully Ti 3AL2.5V bell
- **Size:** for 22.2mm handle bar
- **Weight:** 28g



T-BE02

- **Spec:** Fully Ti 3AL2.5V bell
- **Size:** for 22.2mm handle bar
- **Weight:** 28g



T-SC01

- **Spec:** Ti 6AL4V Columnar top bolts
- **Size:** M5 x 0.8 x 8, 16, 18, 20mm



T-SC02

- **Spec:** Ti 6AL4V Chainwheel locknut bolts
- **Size:** M8 x 0.75 x 8mm



T-SC03

- **Spec:** Ti 6AL4V Columnar top bolts
- **Size:** M6 x 1 x 10, 16, 18, 20mm



T-SC04

- **Spec:** Ti 6AL4V Crank locknut bolts
- **Size:** M15 x 1 x 13mm



T-RD01

- **Spec:** Fully Ti RD pulley 11T
2pcs / set
- **Weight:** 14g / pc



ABZ-2903

- **Spec:** AL6061-T6 Cyclocross / Triathlon aero bar
Length and angle adjustable
Arm holder position adjustable
With comfort EVA patches
For 31.8mm plus shims for 26.0 & 25.4mm handlebar
- **Size:** L345 x 31.8mm
- **Weight:** 590g / set



ABZ-21401

- **Spec:** Super light CARBON barend
Hollowed AL6061 clamp
M6 anti-rust bolts
- **Size:** L80 x 22.2mm
- **Weight:** 65g

ABZ-21203

- **Spec:** AL6061 Comfortable 3D forged & full CNC barend
Option: A. normal end caps
B. conical end caps.
- **Size:** L80 x 22.2mm
- **Weight:** 56g / pr



ABZ-21301

- **Spec:** Nylon fiber with AL6061 barend with LED function
- **Size:** L110 x 22.2mm
- **Weight:** 121g / pr

ABZ-21302 without LED function
Weight: 113g / pr



ABZ-21201

- **Spec:** AL6061 Comfortable 3D forged barend
- **Size:** L90 x 22.2mm
- **Weight:** 140g / pr



ABZ-2902

- **Spec:** Kraton mini design
Palm rest designed clamp
M5 anti-rust bolts
- **Size:** L75 x 22.2mm
- **Weight:** 136g / pr



ABZ-2702

- **Spec:** AL6061 complete CNC machined barend
- **Size:** L85 x 22.2mm
- **Weight:** 58g



ABZ-21204

- **Spec:** AL6061 ultra comfortable barend
- **Size:** Drop 117 x 22.2mm
- **Weight:** 126g / pr



ABZ-21205

- **Spec:** AL6061 ultra barend
- **Size:** L80 x 22.2mm
- **Weight:** 134g / pr



ABZ-21102

- **Spec:** AL6061 Comfortable 3D forged barend
- **Size:** L100 or 120 x 22.2mm
- **Weight:** 130g / pr--100mm
To replace ABZ-2101



ABZ-2003

- **Spec:** Alloy mini oval 1-pc with thumb shape barend
- **Size:** L80 or 100 x 22.2mm
- **Weight:** 144g / 110mm



ABZ-2401

- **Spec:** 2-pc construction 3D ergonomic tubing
With forged head clamp
- **Size:** L100 x 22.2 mm
- **Weight:** 142g / pr



ABZ-21102

- **Spec:** AL6061 Comfortable 3D forged barend
- **Size:** L120 x 22.2mm
- **Weight:** 135g / pr--120mm

To replace ABZ-2101



ABZ-602E

- **Spec:** ACOR Plastic end caps for barend
- **Weight:** 2g / pr



ABZ-2913

- **Spec:** AL6061-T6 top cap and end nut
Hardened elasticity steel stopper
M5 Cr-Mo bolt
- **Size:** 17.0-20.2mm
- **Weight:** 36g / pr



ABB-21401

- **Spec:** Press Fit BB set for Spindle 30
Alloy cap with sealed bearing
- **Size:** Available for BB shell ID 46mm width 68-86.5mm
compatible with Truvativ & FSA system
- **Weight:** 144g
- **Option:** Ceramic bearing

ABB-21402

- **Spec:** Press Fit BB set for Spindle 24
Alloy cap with sealed bearing
- **Size:** Available for BB shell ID 46mm width 86.5mm
with PF30 to Regular Ø 24mm
compatible with Shimano system
- **Weight:** 166g
- **Option:** Ceramic bearing

ABB-21403

- **Spec:** Reducer for Press Fit BB set
Alloy cap with sealed bearing
Covert spindle 24
- **Size:** Available for BB shell ID 46mm width 68mm
with PF30 to Regular Ø 24mm
compatible with Shimano system
- **Weight:** 88g
- **Option:** Ceramic bearing



ABB-21404

- **Spec:** Press Fit external BB set
2 sealed bearing
- **Size:** Shimano 86.5mm Road
Shimano 89.5mm / 92mm MTB
Truvativ 86.5mm Road
Truvativ 89.5mm / 92mm MTB
- **Weight:** 91g
- **Option:** Ceramic bearing



ABB-21001

- **Spec:** ISIS Spindle Threaded BB 1.37"x24T with Alloy cups
Hollow 6AL4V titanium axle cartridge
Sealed bearing
- **Size:** 68 x 108 / 113 / 118mm
73 x 108 / 113 / 118mm
- **Weight:** 165g



ABB-21002

- **Spec:** Threaded BB 1.37"x24T
Hollow Cr-Mo axle DU sealed bearing
Cold-forged steel cups
- **Size:** 68 / 73 x 107-122.5mm
- **Weight:** 270g



ABB-2101

- **Spec:** Threaded BB 1.37" x 24T Alloy cups
Cr-Mo square axle with sealed bearing
- **Size:** 68 x 107 / 110 / 113 / 115 / 118 / 122.5 / 124 / 127.5mm
73 x 110 / 113 / 118 / 122.5 / 124 / 127.5mm
- **Weight:** 276g



ABB-2201

- **Spec:** Threadless design BB
Cr-Mo square axle cartridge
Double sealed bearing
- **Size:** 68 / 73 x 110 / 113 / 116 / 118 / 122.5 / 124 / 127.5mm
- **Weight:** 344g



ABB-21003

- **Spec:** Full Ball bearing for BB 30
- **Weight:** 44g / pr



ABB-2504

- **Spec:** Cr-Mo BB bolt
Resin caps with washer
 - **Size:** M15 x L13mm
 - **Weight:** 30g / pr
- ABB-2503 Alloy caps



ABB-2502

- **Spec:** Cr-Mo BB bolt
With resin caps
For rigid square BB
- **Size:** M8 x L20mm
- **Weight:** 27g / pr



ABL-21401

- **Spec:** Ergonomic design and Top Mount lever
Alloy Cold forged with hinged style clamp lever
For Cyclocross
 - **Size:** OD24.0 / 26.0 / 31.8 mm
 - **Weight:** 93g / pr
- To replace ABL-21002



ABL-2801

- **Spec:** Alloy cold forged auxiliary lever
For Cycle Cross
With Hinge designed bracket
- **Size:** 22.2 to 23.8mm
- **Weight:** 116g / pr



ABL-21003

- **Spec:** Alloy Cold forged lever
For Triathlon / TT
Expandable plug clamp design
- **Size:** 19.6 or 20.6mm
- **Weight:** 158g / pr



ABL-21402

- **Spec:** Alloy forged drop bar brake lever
Quick release mechanism design
For Cycle Cross
For use with linear pull brake design
- **Size:** brake cable type 1.5-1.6mm
- **Weight:** 308g / pr



ABL-21403

- **Spec:** Ergonomic alloy brake lever with KRATON
Integrated bell on left design
Alloy forged 4F lever
For Linear pull brake
- **Size:** 22.2mm handlebar
- **Weight:** 233g / pr



ABL-21201

- **Spec:** Alloy forged 2.5F lever
Two locking-block bracket design
Both for left and right hand to use
For Linear pull brake
- **Size:** 22.2mm handlebar
- **Weight:** 168g / pr



ABL-2402

- **Spec:** Alloy forged 4F lever
CNC cut and comfort cast bracket
For linear pull brake and bracket
For thumb or grip shift systems
- **Size:** 22.2mm handlebar
- **Weight:** 194g / pr



ABL-2905

- **Spec:** AL Die Canti bracket cold forged 2.5F lever
With Pin-pivot
Optional for twist shift or grip shift systems
- **Size:** 22.2mm handlebar
- **Weight:** 208g / pr

To replace ABL-2501



ABR-21201

- **Spec:** Dual pivot Caliper within long arm brake
Cold-forged aluminum arms
EN 55mm brake pads
- **Size:** Dim47-60mm
- **Weight:** 150g / wheel



ABR-2602

- **Spec:** AL6061 melt forged Caliper brake
With dual pivot and QR design
- **Size:** Dim47-57mm or 39-49mm
- **Weight:** 180g / wheel



ABR-21105

- **Spec:** Alloy forged arm V-brake
Dual linear spring tension adjuster
- **Size:** 108mm with EN 70mm brake pads
- **Weight:** 194g / wheel



ABR-21103

- **Spec:** AL6061 forged dual pivot Caliper brake
Light weight with QR design
With adjustable angle cartridge pads
- **Size:** Dim39-51mm
- **Weight:** 164g / wheel



ABR-21401

- **Spec:** Mini V-brake
QR design for cable pipe notch & holder
3D forged aluminum 90mm arms
EN 55mm brake pads
For Cyclocross
- **Size:** Dim20.5-36.5mm
- **Weight:** 145g / wheel



ABR-2903

- **Spec:** Alloy forged arm V-brake
Linear spring
- **Size:** 110mm with EN 60mm brake pads
- **Weight:** 176g / wheel



ABR-2402

- **Spec:** SEAHORSE forged arm V-brake
- **Size:** 110mm or MTB 102mm arm
With 70mm All Weather Pads
- **Weight:** 176g / wheel
- **Option:** Carbon Looking finish



ABR-21402

- **Spec:** Disc rotor - flourish
Durable Stainless Steel CNC machined
OD1.8T/44PCD
- **Size:** 203mm / 180mm / 160mm
- **Weight:** 145g--203mm

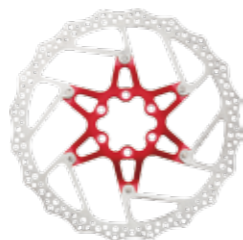

ABR-21403

- **Spec:** Disc rotor -2PC type
Durable Stainless Steel CNC machined
OD1.8T/44PCD
- **Size:** 203mm / 180mm / 160mm
- **Weight:** 129g--203mm



ABR-2210

- **Spec:** ST anti rust angle pipe
- **Size:** 90 / 110D 2pc-set
- **Weight:** 8g

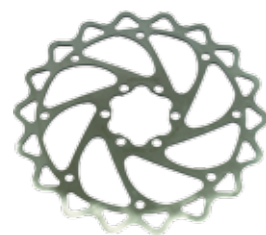

ABR-21101

- **Spec:** Disc rotor - flaming
Stainless Steel CNC machined
- **Size:** 203mm / 180mm / 160mm
- **Weight:** 150g--203mm

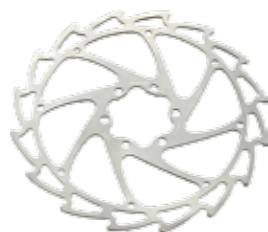

ABR-2910

- **Spec:** Disc rotor - flaming
Stainless Steel CNC machined
- **Size:** 203mm / 180mm / 160mm
- **Weight:** 152g--203mm



ABR-901

- **Spec:** Free angle adjustable lead pipe
For v-brake stainless steel
2pc-set
- **Weight:** 6g



ABR-21001

- **Spec:** Disc rotor - flaming
Stainless Steel CNC machined
- **Size:** 203mm / 180mm / 160mm
- **Weight:** 136g--203mm



ABR-21106

- **Spec:** Disc brake bolt colors
- **Size:** M5x10mm--12pcs/bag
- **Weight:** 24g / bag
- **Option:** bottle packaging is available



ABS-2101

- **Spec:** Metal-Ceramic composite Disc brake pads
2pc-pr
- **Size:** HOPE, MAGURA, SHIMANO, FORMULA, HAYES etc.
- **Weight:** 33g / pr



ABS-21002

- **Spec:** Alloy cartridge pads
Grooved for water designed
Shimano compatible, 2pr-set
- **Size:** 50mm
- **Weight:** 46g / pr



ABS-21202

- **Spec:** Hollowed Alloy cartridge brake shoes
Extra-light holder
2pr / set
- **Size:** 55mm
- **Weight:** 34g / pr



ABS-21202P

Replace cartridge, nine colors for option, 1pr-set, 22g/pr



ABS-21203

Replace 55mm pads for ABS-21202, Six colors for option, 2pr-set



ABS-21004

- **Spec:** Alloy cartridge pads with tire pads
Avoid Pitching over designed
Shimano compatible, 2pr-set
- **Size:** 55mm
- **Weight:** 36g / pr



ABS-2506

- **Spec:** Triple-color cartridge pads
Alloy cage with tire guide bumpers
Shimano compatible
2pr-set
- **Size:** 55mm
- **Weight:** 37g / pr



ABS-21005

Replacement 55mm pads for ABS-21004
2pr-set
Weight: 12g / pr



ABS-2507

Replacement 55mm pads for ABS-2506
2pr-set
Weight: 11g / pr



ABS-208

- **Spec:** Rubber multi-condition For ultra alloy rim 2pr-set
- **Size:** 50mm
- **Weight:** 94g / pr



ABS-21301

- **Spec:** Threaded type brake shoes Safety and night reflector design 2pr / set
- **Size:** 60mm
- **Weight:** 54g / pr



ABS-2804

- **Spec:** Groove design V-brake compatible 2pr-set
- **Size:** 72mm
- **Weight:** 60g / pr



ABS-2701

- **Spec:** Special rubber compound 3-zone V-brake compatible 2pr-set
- **Size:** 72mm
- **Weight:** 64g / pr



ABS-2602

- **Spec:** Rubber compound for TRIAL Threaded type V-brake system 2pr-set
- **Size:** 55mm
- **Weight:** 60g / pr



ABS-21003

- **Spec:** High friction coefficient rubber compound. Fit to usual Magura hydraulic brake 2pc-pr
- **Size:** 50mm
- **Weight:** 21g / pr

ABS-21204

- **Spec:** Alloy CNC designed pads for V-brake Silence design Shimano compatible 2pr-set
- **Size:** 72mm
- **Weight:** 44g / pr



ABS-21204P

Replace cartridge, six colors for option, 1pr-set, 34g / pr



ABS-21205

Replacement 72mm pads for ABS-21204, 2pr-set



ABS-801V

- **Spec:** V-brake shoes Threaded w/screw set 2pr-set
- **Size:** 73mm
- **Weight:** 67g / pr

ABS-801C

threadless for Canti-brake
Weight: 58g / pr



ABS-2301

- **Spec:** Alloy cartridge 3-zone designed replaceable pads w/screws for V-brake 2pr-set
- **Size:** 72mm
- **Weight:** 55g / pr



ABS-2302

Replacement pads for ABS-2301 2pr-set with pins
Weight: 13g / pr



ABS-2803

- **Spec:** Patent printed cartridge V-brake pads Rubber compound Shimano compatible 2pr-set
- **Size:** 72mm
- **Weight:** 56g / pr



ACB-21401

- **Spec:** AL C-Clip for Hydraulic Housing
- **Size:** Ø10.5mm x 5pcs/set
- **Weight:** 2g / set



ACB-21402

- **Spec:** AL cable adjusters
- **Size:** 2pcs / set
- **Weight:** 6g / set



ACB-21303

- **Spec:** Colorful Cable protector 100pcs/box
- **Size:** 10 colors in one box or 4pcs in one bag
- **Weight:** 1g / pc



ACB-21201

- **Spec:** Alloy Cable protector 6pcs / set---3pcs for brake & 3pcs for shifting
- **Size:** 1.2 / 1.8mm
- **Weight:** 6g / set

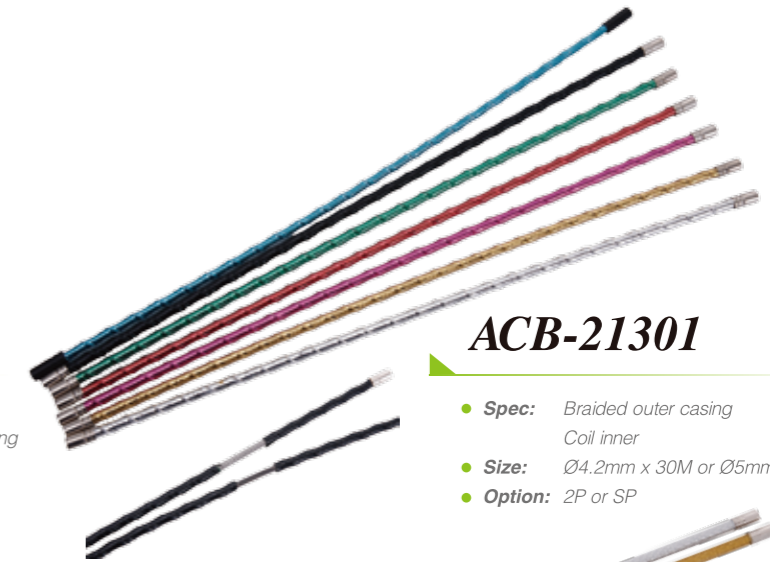

ACB-21301

- **Spec:** Braided outer casing Coil inner
- **Size:** Ø4.2mm x 30M or Ø5mm x 30M
- **Option:** 2P or SP



ACB-2102

- **Spec:** Plastic injection cable holder with 3M sticker Sticks to the fork or frame
- **Size:** M4 and M5 cable housing compatible
- **Weight:** 1g



ACB-21302

- **Spec:** Anodised outer casing Coil inner
- **Size:** Ø4.2mm x 30M or Ø5mm x 30M
- **Option:** 2P or SP



ACB-2402 **ACB-2412**
OD:4.5mm for shifting

- **Spec:** M5 brake cable housing
Silver mesh outer layer
- **Size:** 30M / file box



ACB-2403

- **Spec:** M5 cable housing for both brake & shift wires
Kevlar fiber layer ligh for superb performance especially for cable-actuated disc brakes
- **Size:** 30M / file box



ACB-2405 **ACB-2415**
1x19 OD:1.2xL2000mm with 4.5x4.5 nipple for shifting

- **Spec:** Teflon coated friction free all weather performance
- **Size:** 1 x 19 OD:1.6 x L1700mm with 6 x 7 nipple
100pcs / box



ACA-21002

- **Spec:** Titanium coating 11 SPD Pin L:5.88mm
1/2" x 11 / 128"
DHA Chromizing treatment pin enhanced durability
New self -lubrication AUTO
- **Size:** 116-link
- **Weight:** 210g



ACB-802B **ACB-812B**
1x 19 OD:1.2 x L2000mm with 4.5 x 4.5 nipple for shifting

- **Spec:** Galvanized steel breaking cable
- **Size:** Standard 1 x 12 OD:1.6 x L1700mm with 6 x 7 nipple
100pcs / box



ACB-2404 **ACB-2414**
1x19 OD:1.2xL2000mm with 4.5x4.5 nipple for shifting

- **Spec:** Slick Stainless breaking cable
- **Size:** 1 x 19 OD:1.6 x L1700mm with 6 x 7 nipple
100pcs / box



ACA-21001

- **Spec:** Titanium coating 9 SPD Pin L:6.4mm
1/2" x 11 / 128"
DHA Chromizing treatment pin enhanced durability
Shimano&Campi 9 speed drive train system compatible
New self -lubrication AUTO
- **Size:** 108-link
- **Weight:** 256g



ACA-21003

- **Spec:** 9 SPD Pin L:6.4mm
1/2" x 11 / 128"
DHA Chromizing treatment pin enhanced durability
Shimano / Campi 9 speed drive train system compatible
- **Size:** 116-link
- **Weight:** 298g



ACA-2801

- **Spec:** 9 SPD Anti-Rust
Pin L: 6.6mm
1/2" x 11 / 128"
Salt spray testing over 500hrs
Tensile strength: 1050kgf
Special master pin and assembly instruction attached
- **Size:** 116-link
- **Weight:** 286g



ACA-2704

- **Spec:** 10-SPD
Pin L:5.9mm
1/2" x 11 / 128"
Tensile strength 1250Kgf
Shimano CN7800 compatible
Special master pin and assembly instruction attached
- **Size:** 110-link
- **Weight:** 319g



ACA-2501

- **Spec:** 9 SPD
Hollowed pin 16.35mm
1/2" x 11 / 128"
- **Size:** 116-link
- **Weight:** 274g

ACA-2502
10SPD 1/2" x 11 / 128", L6.1mm

ACA-2503
7 or 8SPD 1/2" x 3 / 32", L7.1mm



ACA-21101

- **Spec:** 7 & 8SPD
1/2" x 3/32"
Deep inner waist chamfer
- **Size:** 116-link
- **Weight:** 334g



ACA-2601

- **Spec:** MASK designed for single SPD
1/2" x 1/8" or 1/2 x 3/32"
Pin L:.9.4mm Power:180kgs
Tensile strength reach 1300kg
- **Size:** 96-link
- **Weight:** 406g



ACA-2007

- **Spec:** Alloy chain adjuster
ARROW looking
- **Size:** For M14 dropout 2pc / set
- **Weight:** 68g



ACA-2006

- **Spec:** Alloy chain adjuster
STAR looking
- **Size:** For M10 dropout 2pc / set
- **Weight:** 62g



ASG-21401

- **Spec:** Two line design for anti-slip grip
2-side lock system
- **Size:** 7/8" x 130mm
- **Weight:** 92g / pr



ASG-21402

- **Spec:** Ergonomics hard-foam grip
2-side lock system
- **Size:** 7/8" x 130mm
- **Weight:** 86g / pr



ASG-21003

- **Spec:** Two Hand-Position designed
Kraton/GEL/Memory foam grip
1-side lock designed with M2.5 Allen key
- **Size:** 7/8" x 148mm
- **Weight:** 265g / pr



ASG-21201

- **Spec:** Skull PP grip
With end caps
- **Size:** 7/8" x 128mm
- **Weight:** 119g / pr



ASG-21405

- **Spec:** Anti-slip silicone grip
- **Size:** 7/8" x 130mm
- **Weight:** 113g / pr



ASG-21302

- **Spec:** Twin layer grip with GEL
- **Size:** 7/8" x 130mm
- **Weight:** 161g / pr



ASG-21109

- **Spec:** Smooth and comfortable grip with GEL grip
2 side lock system with M2.5 Allen key
With end plugs
- **Size:** 135mm
- **Weight:** 84g / pr



ASG-2901

- **Spec:** EVA with Ergo groove grip
PP inner with 2-end Alloy locking system
With end caps
- **Size:** 7/8" x 129mm
- **Weight:** 82g / pr



ASG-21304

ASG-21304R
Safety and night reflector design

- **Spec:** Anti-slip Rubber / GEL grip
With end cap
- **Size:** 7/8" x 128mm
- **Weight:** 190g / pr



ASG-21305

- **Spec:** Rubber / GEL grip
With alloy bar end
- **Size:** 7/8"x128mm



ASG-2806

- **Spec:** PRO MTB grip
Comfort Kraton with PP inner
Alloy ends lock by M3 Allen key
- **Size:** 7/8" x 128mm
- **Weight:** 101g / pr



ASG-21301

- **Spec:** Twin layer Freestyle grip
With end caps
- **Size:** 7/8" x 140mm
- **Weight:** 108g / pr



ASG-2907

ASG-2907B with Bar end

- **Spec:** Kraton with GEL top grip
Ergo palm rest designed
2-side lock designed with M2.5 Allen key
With end caps
- **Size:** 7/8" x 128mm
- **Weight:** 153g / pr



ASG-2911

- **Spec:** Anatomically designed
Kraton / GEL / PP grip
2-side lock designed with M2.5 Allen key
With end caps
- **Size:** 7/8" x 140mm
- **Weight:** 198g / pr

ASG-2912 w/o lock-system

Size: φ30 x130 mm--Man
φ27 x130 mm--Woman
Weight: 182g / pr--Man



ASG-2905

- **Spec:** Kraton with GEL top
PP end plugs
- **Size:** 7/8" x 125mm
- **Weight:** 100g / pr



ASG-2503

- **Spec:** LEVIN Kraton / Rubber 2-tone
Open type with plugs
- **Size:** 7/8" x 125mm
- **Weight:** 90g / pr



ASG-2303

- **Spec:** ATB solid Kraton grip
Open end w/plugs
- **Size:** 130mm
- **Weight:** 92g / pr



ASG-21404

- **Spec:** Scent GEL grip
2 open side system
- **Size:** 7/8" x 128mm
- **Weight:** 91g / pr
ASG-21404R -- with flag design



ASG-21303

- **Spec:** Anti-slip Rubber grip
- **Size:** 7/8" x 115mm
- **Weight:** 67g / pr



ASG-21306

- **Spec:** Anti-slip Rubber / GEL grip
- **Size:** 7/8" x 130mm
- **Weight:** 105 / pr

ASG-21306R

Safety and night reflector design



ASG-21403

- **Spec:** Anti-slip Rubber grip
Closed-end
- **Size:** 7/8" x 125mm
- **Weight:** 200g / pr



ASG-21103

- **Spec:** Kraton / GEL / PP grip
With classical appearance design
1-side lock designed with M2.5 Allen key
With end caps
- **Size:** 7/8" x 134.5mm
- **Weight:** 150g / pr



ASG-21106

- **Spec:** Anti-slippery grip
Groove and hole design
PP / Rubber without Lock-system
- **Size:** M 7/8" x 90mm
L 7/8" x 125mm
- **Weight:** 142g / pr--M
170g / pr--L



ASG-2906

- **Spec:** Kraton with GEL top grip
Ergo palm rest designed
Closed-end
- **Size:** 7/8" x 125mm
- **Weight:** 158g / pr



ASG-2607

- **Spec:** Comfort Kraton / Gel 2-tone grip
Ergonomic palm shape
Closed ends
- **Size:** 7/8" x 130mm
- **Weight:** 158g / pr



ASG-2608

- **Spec:** Comfort solid Kraton
Ergonomic palm shape
Closed ends
- **Size:** 7/8" x 130mm
- **Weight:** 164g / pr



ASG-21205

- **Spec:** Streak Anti-slip grip
PU / Nylon cover and rubber foam
- **Size:** 7/8" x 128mm
- **Weight:** 38g / pr



ASG-21108

- **Spec:** Water resistant foam grip
With end plugs
- **Size:** 7/8" x 125mm
- **Weight:** 34g / pr



ASG-21001

- **Spec:** Super light Wood looking grip
With high density foam
With end plugs
- **Size:** 7/8" x 130mm
- **Weight:** 14g / pr



ASG-2506

- **Spec:** Ergonomic design super light grip
Water resistance foam grip with plugs
- **Size:** 7/8" x 130mm
- **Weight:** 28g / pr



ASG-2104

- **Spec:** Long type comfort foam for
Butterfly-bar grip
- **Size:** 7/8" x 500mm
- **Weight:** 82g / pr



ASG-2809

- **Spec:** Water resistant Neoprene grip
With end plugs
- **Size:** 7/8" x 128mm
- **Weight:** 41g / pr
upgraded from ASG-2706



ASG-21203

- **Spec:** Brush effect with EVA cork bar tape
Comfortable designed with end caps
- **Size:** 3 x 185cm
- **Weight:** 55g / pr



ASG-21204

- **Spec:** Anti slippery PU bar tape
Golf designed with end caps
- **Size:** 3 x 200cm
- **Weight:** 75g / pr



ASG-21105

- **Spec:** Anti slippery bar tape
With GEL sticker resistance
To stretching, heat, water, and aging.
With end caps
- **Size:** 3 x 190cm
- **Weight:** 112g / pr

ASG-2906

- **Spec:** Kraton with GEL top grip
Ergo palm rest designed
Closed-end
- **Size:** 7/8" x 125mm
- **Weight:** 158g / pr

ASG-2607

- **Spec:** Comfort Kraton / Gel 2-tone grip
Ergonomic palm shape
Closed ends
- **Size:** 7/8" x 130mm
- **Weight:** 158g / pr

ASG-2608

- **Spec:** Comfort solid Kraton
Ergonomic palm shape
Closed ends
- **Size:** 7/8" x 130mm
- **Weight:** 164g / pr



ASG-21005

- **Spec:** Leather looking bar tape with soft Microfiber
With end caps
- **Size:** 3 x 190cm
- **Weight:** 58g / pr



ASG-2801

- **Spec:** DOT PU skin with GEL foam
Flexible and comfortable
With end caps
- **Size:** 3 x 190mm
- **Weight:** 45g / pr



ASG-2501

- **Spec:** Carbon looking bar tape with GEL foam With carbon end caps
- **Size:** 3 x 190cm
- **Weight:** 56g / pr



ASG-2404

- **Spec:** Bar tape comfort enhanced EVA foam / soft GEL Water resistance with end plugs
- **Size:** 3 x 185cm
- **Weight:** 36g / pr



ASG-2510

- **Spec:** ACOR Carbon end caps
- **Size:** For barend
- **Weight:** 6g / pr



ASG-2511

- **Spec:** ACOR REFLECTIVE end caps
- **Size:** For road bar type
- **Weight:** 6g / pr



AHB-21407

- **Spec:** AL6061-T6 for 29ER bar
- **Size:** 710~740mm (c-c)
- **Barbore:** 31.8mm
- **Weight:** 322g



AHB-21001

- **Spec:** AL7075-T6 with Carbon Straight bar
- **Bend:** 5°
- **Size:** 540 or 560mm
- **Barbore:** 25.4mm
- **Weight:** 104g~540mm
120g~560mm



AHB-21002

- **Spec:** AL7075-T6 with Carbon Rise 15° bar
- **Bend:** 20°
- **Size:** 600 or 620mm
- **Barbore:** 31.8mm
- **Weight:** 210g~600mm
212g~620mm



AHB-21003

- **Spec:** AL7075-T6 with Carbon Straight bar
- **Bend:** 5°
- **Size:** 580 or 600mm
- **Barbore:** 31.8mm
- **Weight:** 138g~580mm
132g~600mm



AHB-2901

- **Spec:** Super light CARBON Low rise bar
- **Size:** W660 x R20 x 25.4mm
- **Weight:** 180g

AHB-2902 31.8mm
Weight: 214g



AHB-2903

- **Spec:** Super light CARBON Straight bar
- **Size:** W580 x 25.4mm
- **Weight:** 158g



AHB-2401

- **Spec:** Alloy 6061 straight bar
- **Bend:** 5°
- **Size:** W600 x T1.65 / 1.2
- **Barbore:** 31.8mm
- **Weight:** 161g



AHB-802

- **Spec:** AL6061-T6 straight bar
- **Bend:** 5°
- **Size:** W600 x T2.4 / 1.2
- **Barbore:** 25.4mm
- **Weight:** 166g

To replace AHB-2206



AHB-21402

- **Spec:** AL6061-T6 D/B bar (urban style) with holes
- **Rise:** 70mm / Sweep:35
- **Size:** 660mm (c-c)
- **Barbore:** 31.8
- **Weight:** 284g~31.8



AHB-21301

- **Spec:** AL6061-T6 D/B rise bar
- **Reach:** 25mm ,Sweep: 21°
- **Size:** 480mm (c-c)
- **Barbore:** 25.4mm
- **Weight:** 166g



AHB-21303

- **Spec:** AL6061-T6 D/B rise bar
- **Size:** 480mm (c-c)
- **Barbore:** 31.8 *R38 *Sweep: 5°/ 6°
- **Weight:** 270g

AHB-21303B

- **Spec:** AL6061-T6 D/B rise bar
- **Size:** 450 / 510 / 560mm (c-c)
- **Barbore:** 25.4 *R70 *Sweep: 5°/ 6°
- **Weight:** 270g



AHB-2201

- **Spec:** Alloy ATB low rise bar
- **Bend:** 9°
- **Size:** W640 / 680 x R30 x T3.0 / 1.8
- **Barbore:** 25.4mm
- **Weight:** 340g



AHB-2501

- **Spec:** AL6061 classical design comfort city bar
- **Size:** W600 x R26 x T2.6mm
- **Barbore:** 25.4mm
- **Weight:** 372g

To replace AHB-203



AHB-21304

- **Spec:** AL6061-T6 D/B road bar
- **Reach:** 80mm / Drop: 125mm
- **Size:** 400, 420, 440mm, 460mm (O-O)
- **Barbore:** 25.4mm or 31.8mm
- **Weight:** 296g~460mm(o-o)



AHB-21305

- **Spec:** AL6061-T6 D/B road bar with Flat design
- **Reach:** 80mm / Drop: 130mm
- **Size:** 400, 420, 440mm, 460mm (O-O)
- **Barbore:** 25.4mm or 31.8mm
- **Weight:** 336g~460mm(o-o)



AHB-21201

- **Spec:** AL6061-T6 D/B road bar
- **Reach:** 95mm / Drop: 150mm
- **Size:** 400, 420, 440mm
- **Barbore:** 26.0mm
- **Weight:** 225g~440mm



AHB-21202

- **Spec:** AL-7075-T6 D/B with carbon fiber road bar
- **Reach:** 75mm / Drop: 158mm
- **Size:** 400, 420, 440mm
- **Barbore:** 26.0mm
- **Weight:** 284g~26.0 x 400mm



AHB-21403

- **Spec:** AL6061-T6 D/B bar (urban style) with holes
- **Size:** 390mm (c-c)
- **Barbore:** 26.0mm
- **Weight:** 245g--26.0



AHB-21401

- **Spec:** AL6061-T6 D/B bar (urban style)
 - **Size:** 360, 380, 400, 420, 440mm (c-c)
 - **Barbore:** 25.4 or 26.0mm
 - **Weight:** 210g--26mm
- To replace AHB-2710**



AHB-21302

- **Spec:** AL6061-T6 D/B bar
- **Size:** 400, 420, 440mm (c-c)
- **Barbore:** 26.0 or 31.8
- **Weight:** 280g--26.0



AHB-702

- **Spec:** AL6061-T6 cross bar
- **Size:** W190mm with quick release designed clamps
- **Weight:** 124g



AHB-21404

- **Spec:** Extend computer/Light bar AL6061 CNC machined
- **Size:** Fit to 31.8mm handlebar
- **Weight:** 58g



AHB-21405

- **Spec:** Extend computer/Light bar AL6061 CNC machined
- **Size:** Fit to 31.8mm handlebar
- **Weight:** 30g

AHB-21406 -- With Electric power



AHB-2307

- **Spec:** AL6061 3D forged expanding bar Angle adjustable
- **Size:** Compatible to handlebar 25.4mm Extension 50mm
- **Weight:** 198g



AHB-2711

- **Spec:** Extend computer bar AL6061 CNC machined
- **Size:** Fit to 31.8mm handlebar With CARBON 22.2mm computer bar
- **Weight:** 54g



AHS-21402

- **Spec:** AL Double locked Integrated Threadless headset Alloy with sealed bearing Compressing ring to prevent loosening and safety design Even the head tube is removed, The steerer and frame remain tight.
- **Size:** 1 1/8" 28.6 x 41 x 30 x H:17.4mm
1 1/8" 28.6 x 41.8 x 30 x H:17.4mm
- **Weight:** 98g



AHS-21201

- **Spec:** AL Integrated Threadless headset--Economy type Alloy top cover with Steel crown race cartridge bearing
- **Size:** 1 1/8" 28.6 x 41.8 x 30 x H:10mm
- **Weight:** 104g

AHS-21201A with alloy crown race

- **Size:** 1 1/8" to 1 1/4" 28.6 x 41.8 x 46.9 x 33 x H:10mm
1 1/8" to 1.5" 28.6 x 41.8 x 51.8 x 39.8 x H:16.8mm



AHS-21202

- **Spec:** AL Threadless headset Alloy top cover with alloy crown race sealed bearing
- **Size:** 1 1/8" 28.6 x 34 x 30 x H:29mm
- **Weight:** 104g



AHS-21001

- **Spec:** Integrated threadless Sealed bearing AL 6061 CNC top cover AL 7075 CNC crown race
- **Size:** 1-1/8" upper & 1-1/4" lower
- **Weight:** 73g



AHS-21004

- **Spec:** Easy Drop-in Integrated threadless for Campagnolo Sealed cartridge with top cap
- **Size:** 1-1/8" 28.6 x 41.8 x 30 x H11.5mm
- **Weight:** 68g



AHS-21005

- **Spec:** Integrated threadless Sealed bearing AL 6061 CNC top cover AL7075 CNC crown race
- **Size:** 1-1/8" upper & 1.5" lower
- **Weight:** 79g



AHS-21003

- **Spec:** 6pcs / set Threaded Cartridge bearings Alloy cap
- **Size:** 1" 25.4 x 22.2 x 30 x 27 x H37.5mm
- **Weight:** 109g



AHS-21101

- **Spec:** AL threadless headset Sealed bearing AL 6061 CNC top cover
- **Size:** 1 1/8" 28.6 x 34 x 30 x H:25.7mm
- **Weight:** 95g



AHS-2901

- **Spec:** Threadless ST upper and lower cups Caged bearings
- **Size:** 1-1/8" 25.4 x 34 x 30mm
- **Weight:** 108g



AHU-21203F/R

- **Spec:** AL6 shell with cut flange front hub AL6061 axle alloy QR is available 9SPD cassette body M9 x 100mm 2 sealed bearings -- Front M10 x 130mm 4 sealed bearings -- Rear
- **Size:** 28, 32, 36H
- **Weight:** 202g / 28H Front 272g / 32H Rear



AHU-21001F/R

- **Spec:** AL6 shell MTB XC Disc brake system With CNC cut flange and end caps AL6061 axle with alloy QR Cr-Mo Shimano 9SPD cassette body M9 x 100/108mm 2 Japanese sealed bearing -- Front M10 x 130/140mm 4 Japanese sealed bearing -- Rear
- **Size:** 28, 32, 36H
- **Weight:** 180g / 32H Front 288g / 32H Rear



AHS-701

- **Spec:** Alloy threadless aheadset Ball retainer and AL top cap
- **Size:** 1" 25.4 x 30 / 30.2x27 / 26.4mm H32.05mm 1-1/8" 28.6 x 34 x 30mm H27.5mm
- **Weight:** 106g



AHS-21002

- **Spec:** Integrated for Campagnolo 6pcs / set Sealed bearing HIPCA CARBON top cover SPCC+NBR crown race
- **Size:** 1-1/8" 28.6 x 41 x 30 x H21.95mm
- **Weight:** 68g



AHS-2902

- **Spec:** Integrated threaded AL CNC top cover and lock nut Sealed bearings 45° AL7075 CNC crown race
- **Size:** 1-1/8" 25.4 x 34 x 30mm
- **Weight:** 85g



AHU-21004F/R

- **Spec:** Carbon Shell with CNC cut flange and end caps AL7075 axle with alloy QR M9 x 100mm 2 sealed bearings -- Front M10 x 135mm 4 sealed bearings -- Rear
- **Size:** 24H, 28H, 32H, 36H
- **Weight:** 146g / 36H Front 289g / 36H Rear



AHU-21002F/R

- **Spec:** AL6 shell with CNC cut flange and end caps AL6061 axle with alloy QR Cr-Mo shimano or campy cassette body M9 x 100/108mm 4 Japanese sealed bearing -- Front M10 x 130/140mm 4 Japanese sealed bearing -- Rear
- **Size:** 20H, 24H
- **Weight:** 71g / 20H Front 248g / 24H Rear

AHS-21401

- **Spec:** AL Double locked Semi-Integrated headset Alloy with sealed bearing compressing ring to prevent loosening and safety design Even the head tube is removed, the steerer and frame remain tight.
- **Size:** 1 1/8" 28.6 x 44 x 30 x H:21.4mm
- **Weight:** 124g



AHS-2904

- **Spec:** Semi-integrated 1-1/8" AL CNC upper cup 1.5" ST lower cup Top 5/32" & lower 7/32" ball bearings
- **Size:** 1-1/8" to 1.5" 28.6 x 49.7 x 30 x 56.5mm
- **Weight:** 205g



AHS-2503

- **Spec:** MTB Semi-integrated threadless AL/ST
- **Size:** 1-1/8" 28.6 x 44 x 30 x H8.5mm Semi-cartridge
- **Weight:** 100g



AHS-2504

- **Spec:** MTB Semi integrative threadless AL
- **Size:** 1-1/8" 28.6 x 44 x 30 x H9.3mm Sealed-cartridge
- **Weight:** 77g



AHU-21003F/R

- **Spec:** Carbon Shell with AL CNC cut flange and end caps AL7075 axle with alloy QR M9 x 100mm 2 sealed bearings -- Front M10 x 130mm 4 sealed bearings -- Rear
- **Size:** 20, 24, 28, 32, 36H
- **Weight:** 90g / 20H Front 258g / 24H Rear



AHU-21201F/R

- **Spec:** AL6 shell with cut flange front hub AL6061 axle M9 x 100mm 2 Japanese sealed bearings -- Front M10 x 120mm 2 Japanese sealed bearings -- Rear
- **Size:** 28, 32, 36H
- **Weight:** 244g / 32H Front 296g / 32H Rear



AHU-21202F/R

- **Spec:** AL6 shell with cut flange front hub
AL6061 axle, alloy QR is available
M9 x 100mm 2 Japanese sealed bearings -- Front
M10 x 120mm 2 Japanese sealed bearings -- Rear
- **Size:** 28, 32, 36H
- **Weight:** 202g / 32H Front
248g / 32H Rear



AHU-21005F/R

- **Spec:** AL Shell with cut flange
AL7075 axle, sealed bearings
16T and 18T fixed cog and lock ring available
3/8" x 100mm x 140mm -- Front
3/8" x 130 or 120mm x 170mm -- Rear
- **Size:** 32, 36H
- **Weight:** 264g / 32H Front
315g / 32H Rear



APD-21203

- **Spec:** High polish AL6061 CNC Body
9/16" Cr-Mo axle with LSL & sealed bearings
Toe clip and Leather Toe strap are including
- **Size:** 99 x 62 x 19mm
- **Weight:** 406g / pr
- **Option:** double hole toe clip
- **Weight:** 462g / pr



APD-21005

- **Spec:** Racing pedal alloy body
Clipless compatible to LOOK "KEO" CLEAT
9/16" Cr-Mo axle with ball bearings
- **Size:** 78 x 90.8 x 33.1 mm
- **Weight:** 285g / pr



APD-21408

- **Spec:** Pedal pins
45pc/set with anging plating tool
- **Size:** M4 / T20
- **Weight:** 69g with bottle



APD-21310

- **Spec:** Pedal axle adapter
2pc/set
- **Size:** 9/16" to 1/2"
1/2" to 9/16"
- **Weight:** 28g / pc



APD-21008

- **Spec:** Racing pedal alloy body
Clipless compatible to LOOK "ARC" CLEAT
9/16" Cr-Mo axle with sealed bearings
- **Size:** 84.1 x 90.8 x 32.9 mm
- **Weight:** 342g / pr



APD-21006

- **Spec:** Multi-function AL body and cage
1-side binding tension adjustable
9/16" Cr-Mo axle with sealed bearings
- **Size:** 93 x 66 x 30.1 mm
- **Weight:** 354g / pr

APD-21009

- **Spec:** Aluminium die cast body
Clipless compatible to Shimano
"SPD" CLEAT 9/16" Cr-Mo axle
DU/Sealed bearings
- **Size:** 80.9 x 65.3 mm
- **Weight:** 324g / pr



APD-21302

- **Spec:** Racing pedal with HIPAC Carbon body
9/16" CR-MO axle with sealed bearing
Adjustable tension 80~180kgf-cm
- **Size:** 82 x 92 mm
- **Weight:** 280g / pr



APD-21307

- **Spec:** Racing pedal with plastic body
9/16" CR-MO axle with sealed bearing
- **Size:** 89 x 81 x 32.5 mm
- **Weight:** 249g / pr



APD-21311

- **Spec:** ALLOY cage and body with clipless pedal
9/16" Cr-Mo axle with sealed bearings
 - **Size:** 104 x 63.2 x 28mm
 - **Weight:** 320g / pr
- To replace APD-2304



APD-2902

- **Spec:** Alloy body and cage
Ball bearings
Toe clip attachable
9/16" Cr-Mo axle
- **Size:** 90 x 64.5 X 27.5 mm
- **Weight:** 238g / pr



APD-2502

- **Spec:** Alloy cage and body
Toe clip attachable
Snap-on BS reflectors
9/16" Cr-Mo axle ball bearings
- **Weight:** 249g / pr



APD-703

- **Spec:** PP body Alloy cage
Toe clip attachable with BS reflectors
9/16" Cr-Mo axle ball bearings
- **Weight:** 320g / pr



APD-21105

- **Spec:** 1-pc AL6061 cage and body
Reflector attachable
9/16" Cr-Mo axle sealed bearings
 - **Size:** 98 x 63 x 23 mm
 - **Weight:** 250g / pr
- To replace APD-21010*



APD-21306

- **Spec:** Alloy die casting body pedal
9/16" Cr-Mo axle with ball bearings
BS reflectors
- **Weight:** 331g / pr



APD-21202

- **Spec:** 1-PC PP body
BS reflectors
9/16" Boron steel axle with ball bearings
- **Size:** 90 x 75 x 20 mm
- **Weight:** 236g / pr



APD-21103

- **Spec:** 1-PC Plastic body slipless TPR tread
BS reflectors
9/16" Cr-Mo axle with ball bearings
- **Size:** 111 x 98.7 x 26.5 mm
- **Weight:** 288g / pr



APD-21004

- **Spec:** 1-PC alloy forged body
DU sealed bearings
9/16" CNC Cr-Mo axle
- **Size:** 98.3 x 60.6 x 18 mm
- **Weight:** 238g / pr

APD-21004Q with Quick release system
Weight: 312g / pr
To replace APD-2303

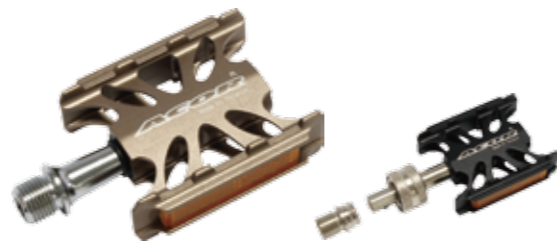

APD-21102

- **Spec:** AL6061 CNC Body
BS reflectors
9/16" Cr-Mo axle with sealed bearings
- **Size:** 87 x 61 mm
- **Weight:** 205g / pr

APD-21102Q with Quick release system
Size: 100 x 61mm
Weight: 326g / pr
To replace APD-2904



APD-21304

- **Spec:** URBAN pedal
9/16" Taper Cr-Mo axle
With ball bearings
BS reflectors
- **Size:** 110 x 80 mm
- **Weight:** 335g / pr



APD-21404

- **Spec:** Alloy body with quick release pedal
9/16" Cr-Mo axle with sealed bearings
Easy to attach and remove
Easily lock the pedal to the spoke as a locking tool
- **Size:** 102 x 100 x 26mm
- **Weight:** 415g / pr



APD-21406

- **Spec:** Alloy cage with Plastic body
9/16" CR-MO axle with ball bearing
BS reflectors
- **Size:** 104 x 63.2 x 24 mm
- **Weight:** 240g / pr



APD-21401

- **Spec:** AL6061 forged super thin pedal
9/16" Cr-Mo axle with 2 DU sealed bearings
Replaceable pins
- **Size:** 98 x 64 x 12.8mm
- **Weight:** 200g / pr



APD-21305

- **Spec:** URBAN pedal with alloy cage and plastic body
9/16" Boron steel axle with ball bearings
BS reflectors
- **Size:** 110 x 80 x 25 mm
- **Weight:** 267g / pr



APD-21007

- **Spec:** 1-PC PP body slipless TPE tread
BS reflectors
9/16" Cr-Mo axle ball bearings
 - **Size:** 101.5 x 72 x 21.6 mm
 - **Weight:** 245g / pr
- To replace APD-2505*



APD-21207

- **Spec:** Alloy body with Non-slip Kraton top pedal
9/16" Cr-Mo axle with ball bearings
BS reflectors
- **Size:** 90 x 75mm
- **Weight:** 285g / pr
To replace APD-2903, APD-2501



APD-21303

- **Spec:** Nylon Filber pedal
9/16" Boron steel axle with ball bearings
BS reflectors
- **Size:** 115 x 106 x 21mm
- **Weight:** 345g / pr



APD-21204

- **Spec:** 1-PC polycarbonated body
BS reflectors
9/16" Boron steel axle with ball bearings
- **Size:** 110 x 100 x 25 mm
- **Weight:** 455g / pr



APD-2909

- **Spec:** 1-PC PP body
Slipless Kraton top
3-side BS reflector
9/16" Boron axle with ball bearings
- **Size:** 100 x 84 x 27 mm
- **Weight:** 396g / pr



APD-21301

- **Spec:** Nylon Filber pedal
9/16" Cr-Mo axle with ball bearings
BS reflectors
- **Size:** 100 x 105 x 24mm
- **Weight:** 344g / pr



APD-21205

- **Spec:** 1-PC Hi-impact body with EDC colors spindle & Cap
9/16" Cr-Mo axle with ball bearings
- **Size:** 110 x 100 x 32 mm
- **Weight:** 410g / pr



APD-21003

- **Spec:** 1-PC PC body slipless TPR tread
9/16" Cr-Mo axle with ball bearings
- **Size:** 111 x 102.7 x 28 mm
- **Weight:** 360g / pr

APD-21003UV with UV function for different colors changing



APD-21403

- **Spec:** AL6061 CNC super thin pedal
9/16" Cr-Mo axle with 2 DU sealed bearings
replaceable pins
- **Size:** 108 x 106 x 12.5mm
- **Weight:** 390g / pr



APD-21308

- **Spec:** AL6061 CNC super thin pedal
9/16" Cr-Mo axle with 2 DU sealed bearings
- **Size:** 100 x 105 x 18mm
- **Weight:** 318g / pr



APD-2905

- **Spec:** Aluminum body
Replaceable pins by wrench
9/16" CNC Cr-Mo axle DU/Sealed bearings
- **Size:** 93 x 90 x 28 mm
- **Weight:** 304g / pr

APD-21402

- **Spec:** AL6061 CNC super thin pedal
9/16" Cr-Mo axle with 2 DU sealed bearings
replaceable pins
- **Size:** 108 x 100 x 13mm
- **Weight:** 276g / pr



APD-21407

- **Spec:** Nylon Filber pedal
9/16" Cr-Mo axle with ball bearings
BS reflectors
- **Size:** 111 x 100 x 27mm
- **Weight:** 340g / pr



APD-21309

- **Spec:** AL6061 CNC super thin pedal
9/16" Cr-Mo axle with 2 DU sealed bearings
- **Size:** 100 x 105 x 18mm
- **Weight:** 298g / pr



APD-2604

- **Spec:** AL body ST double cage
9/16" Boron axle with ball bearings
- **Size:** 96 x 97 mm
- **Weight:** 532g / pr



APD-21107

- **Spec:** Vacuum Plate series
Reflector attachable
- **Size:** 100 x 110 x 25 mm
- **Weight:** 392g / pr



ASD-21401

- **Spec:** EVA foam horizontal saddle
Manganese rail
Enlarge rider's pedaling force
Healthy design
- **Weight:** 267g



ASD-21302

- **Spec:** Fix geared design saddle
ST Cr-Moly rail
- **Size:** 273 x 140mm
- **Weight:** 285g



ASD-21301

- **Spec:** Pro riding with EVA foam saddle
ST rail
- **Size:** 280 x 135mm
- **Weight:** 289g



ASD-21303

- **Spec:** Pro riding design
1pc design without bolts
Cr-Moly rail, Resin F&R Bumper
- **Size:** 272 x 130mm
- **Weight:** 216g



ASD-21304

- **Spec:** Flat design for Pro riding saddle
Cr-Moly rail, Resin F&R Bumper
- **Size:** 270 x 140mm
- **Weight:** 366g



ASD-21201

- **Spec:** Pro riding v-cut design
PU Vinyl top with light foam
Cr-Moly rail, Resin F&R Bumper
- **Size:** 275 x 130mm
- **Weight:** 254g



ASD-21003

- **Spec:** Road Racing ergonomic shape
Fully Carbon V-cut with love channel
Carbon rail
- **Size:** 265 x 140mm
- **Weight:** 110g



ASD-21001

- **Spec:** PRO riding & Ergonomic shape designed
PU Vinyl top and Gel padding
Cr-N / Ti Al rail system.
Resin F&R Bumper
- **Size:** 274 x 130mm
- **Weight:** 233g



ASD-2901

- **Spec:** Ergo HOLLOWED design
Glass fiber base with F&R bumpers
PU skin with GEL
Shock absorbing CrN/Ti rail system
- **Size:** 287 x 130mm
- **Weight:** 246g



ASD-21101

- **Spec:** Double density base
PRO riding & Ergonomic shape design
Microfiber top with flower pattern
Cr-Moly rail, Resin F&R Bumper
- **Size:** 296 x 137mm
- **Weight:** 324g



ASD-21102

- **Spec:** PU Vinyl with light foam and Ergonomic shape
Traditional style
Cr-Moly rail, Resin F&R Bumper
- **Size:** 274 x 153mm
- **Weight:** 290g



ASD-21204

- **Spec:** Pro riding design
Recreation base with PU foam
Cr-Moly rail, Resin F&R Bumper
- **Size:** 272 x 142mm
- **Weight:** 265g



ASD-2805

- **Spec:** Nylon fiber base
PU Vinyl top with super light foam
Resin F&R bumpers
CrN/Ti Al rail
- **Size:** 285 x 140mm
- **Weight:** 224g



ASD-21207

- **Spec:** Junior style with PU foam
ST rail, Resin F&R Bumper
- **Size:** 245 x 150mm--Butterfly, Flower (Girl)
245 x 150mm--School style (Boy)
- **Weight:** 312g



ASD-21105

- **Spec:** Junior style with High Density Vinyl cover
Safety with Rear light
ST rail, Resin F&R Bumper
- **Size:** 244 x 155mm--Black & Red (Girl)
Army (Boy)
- **Weight:** 368g



ASD-2902

- **Spec:** Kids / Junior designed
PP base with F&R bumpers
ST rail and PU skin top
Safety rear light equipped
- **Size:** 248 x 130mm (Boy)
226 x 135mm (Girl)
- **Weight:** 309g



ASD-21305

- **Spec:** Comfortable riding saddle
Hard-wearing PU top
ST rail, Resin F&R Bumper
- **Size:** 250 x 150mm
- **Weight:** 389g



ASD-21202

- **Spec:** Recreation Double density base
Fashion style
Comfortable with Flat sit-zone and depressed area
Cr-Moly rail, Resin F&R Bumper
- **Size:** 265 x 200mm
- **Weight:** 406g



ASD-21205

- **Spec:** Recreation base with PU foam
City free style
Comfortable with Flat sit-zone and depressed area
Cr-Moly rail, Resin F&R Bumper
- **Size:** 276 x 155mm--Man
260 x 155mm--Lady
- **Weight:** 320g--Man, 315g--Lady



ASD-21206

- **Spec:** Recreation base with PU foam
Comfortable with Flat base
Cr-Moly rail, Resin F&R Bumper
- **Size:** 265 x 140mm
- **Weight:** 305g



ASD-21103

- **Spec:** Recreation Double density base with Gel padding
PU Cover with trandional pattern
Cr-Moly rail, Resin F&R Bumper
- **Size:** 262 x 198mm--Lady
280 x 178mm--Man
- **Weight:** 448g--Lady, 402g--Man



ASD-21104

- **Spec:** Recreation Double density base
Comfortable with Flat sit-zone and depressed area
Cr-Moly rail, Resin F&R Bumper
- **Size:** 240 x 160mm--Lady
260 x 158mm--Man
- **Weight:** 314g--Lady
308g--Man



ASD-2904

- **Spec:** Double density base
PU Vinyl top and Gel padding
Cr-Moly rail,
Resin F&R Bumper
- **Size:** 246 x 169mm
- **Weight:** 360g



ASD-2712

- **Spec:** Double density hollowed base
PU Vinyl top with high density foam
Steel rail with mini elastomer
Resin F&R bumpers
- **Size:** 279 x 170mm--Man
264 x 190mm--Lady
- **Weight:** 434g--Man, 382g--Lady
To replace ASD-2505



ASD-2811

- **Spec:** PP base
PU Vinyl top with high density foam
Steel rail with spring
- **Size:** 250 x 225mm
- **Weight:** 623g



ASD-2711

- **Spec:** Double density O-cut base
PU Vinyl top with Membery foam
Steel rail with elastomer
Resin F&R bumpers
- **Size:** 265 x 210mm--Man
240 x 210mm--Lady
- **Weight:** 717g--Man, 810g--Lady



ASD-21306

- **Spec:** Comfortable riding saddle
Hard-wearing PU top with elastomer
ST rail, Resin F&R Bumper
- **Size:** 260x175mm
- **Weight:** 586g



ASD-21107

- **Spec:** GEL tech saddle cover-COLORS
With tie strap
- **Size:** 254 / 269 x 254 / 203mm
- **Weight:** 186g



ASD-2601

- **Spec:** Super light BODY-FIT FOAM saddle cover
Flexible for saddle
 - **Size:** L 254 / 280 x 178 / 203mm
S 249 / 274 x 140 / 165mm
 - **Weight:** 149g--L, 123g--S
- To replace ASD-702**



ASD-2405

- **Spec:** Ultra light MTB GEL tech ergonomic saddle cover
 - **Size:** 254 / 280 x 178 / 203mm
 - **Weight:** 318g
- ASD-2406 -- 249 / 274 x 140 / 165mm**
Weight: 240g



ASP-21401

- **Spec:** AL6061 seat post with 3D
Forged head wider angle adjustable
- **Size:** 27.2 or 31.6 x 350mm
- **Weight:** 322g



ASP-21302

- **Spec:** AL6061 offset:15mm seat post with 2D
Forged head
- **Size:** 27.2 , 31.6 x 350mm
- **Weight:** 300g



ASP-21301

- **Spec:** AL6061 seat post with 2D
Forged head wider angle adjustable
- **Size:** 27.2 , 31.6 x 350mm
- **Weight:** 310g

ASP-21305

- **Spec:** AL7075 seat post with Cr-MO bolt
Simply and easily angle adjustment design
- **Size:** 27.2, 30.9, 31.6 x 350mm
- **Weight:** 167g

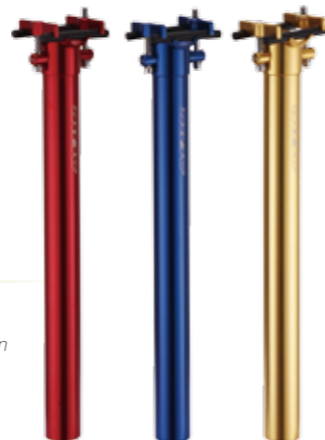

ASP-21306

- **Spec:** AL2014 offset: 20mm seat post
Simply and easily angle adjustment design
- **Size:** 27.2, 31.6 x 350mm
- **Weight:** 252g--27.2



ASP-21201

- **Spec:** 1-bolt designed seat post
Simply and easily angle adjustment design
2D AL6061 with offset:15mm
- **Size:** 27.2, 31.6 x 350mm
- **Weight:** 306g



ASP-21202

- **Spec:** 1-bolt designed AL6061 seat post
Side-taper clamping force design
offset:20mm
Rise:-15° to +15°
- **Size:** 27.2 x 350mm
- **Weight:** 310g



ASP-21203

- **Spec:** 2-bolt designed AL6061 seat post
Side by side dual bolt design
offset:25mm
- **Size:** 27.2 x 350mm
- **Weight:** 358g



ASP-2902

- **Spec:** PUMP post
AL6061 tubing and 1-bolt clamp
Hidden hose with Schrader valve
- **Size:** 27.2 x 350mm
- **Weight:** 391g

ASP-2902A
attach presta valve replacement



ASP-2001

- **Spec:** AL6 Cold-forged head 1-bolt clamp seat post
- **Size:** 25.0 to 31.8 x L400mm
- **Weight:** 280g



ASP-21303

- **Spec:** AL6061 suspension 1-PC seat post with 2D forged head 40mm Travel
- **Size:** 27.2, 30.6, 30.9, 31.6 x 350mm
- **Weight:** 538g---31.6mm



ASP-21304

- **Spec:** AL6061 suspension seat post with 2D forged head 40mm Travel, angle adjustment
- **Size:** 27.2, 30.6, 30.9, 31.6 x 350mm
- **Weight:** 400g---31.6mm



ASP-2903

- **Spec:** Suspension seat post
Travel: 40mm with AL6061 tubing
Non-loose 2-bolt clamp
Preload adjustable
- **Size:** 27.2 x 350mm
- **Weight:** 480g



ASP-2504

- **Spec:** MDU suspension w/o rubber boot seat post AL6 tubing
- **Size:** 26.8 to 31.8 x 350L
- **Weight:** 433g

To replace ASP-2403 & 2404



ASP-2305

- **Spec:** Suspension designed Alloy tube 1-bolt head preload adjustable
Travel: 35mm
- **Size:** 25.4 to 31.8 x L350mm
- **Weight:** 470g



AQR-2101

- **Spec:** Alloy shim L80mm
- **Size:** ID25.4 or 27.2 OD to order to fit most sizes seat posts
- **Weight:** 36g



AQR-21001

- **Spec:** AL6061 FD clamp M4 stainless bolt
- **Size:** 31.8 or 34.9 mm
- **Weight:** 33g / 31.8mm , 27g / 34.9 mm



AQR-21003

- **Spec:** FD clamp alloy extruded Derailleur 9°+20mm offset
- **Size:** 31.8 or 35mm
- **Weight:** 24g / 31.8mm, 25g / 35mm



AQR-2004

- **Spec:** Alloy extruded FD clamp
- **Size:** 28.6, 31.8, 34.9mm
- **Weight:** 29g



AQR-2502

- **Spec:** AL6061 seat clamp M5 eyelets for rear carrier
- **Size:** 31.8, 34.9mm
- **Weight:** 37g



AQR-2601

- **Spec:** Super light Alloy extruded hollowed FD clamp
- **Size:** 31.8, 34.9mm
- **Weight:** 18g



AQR-2705

- **Spec:** AL6061 seat clamp M5 eyelets for rear carrier
- **Size:** 28.6, 31.8, 34.9mm
- **Weight:** 35g / 33g / 35g



AQR-21303

- **Spec:** AL7075-T6 CNC with stainless bolt seat clamp
- **Size:** 31.8 or 34.9 mm *H25mm
- **Weight:** 18g / 31.8mm, 18g / 34.9 mm



AQR-21403

- **Spec:** AL6061 CNC clamp with carrier function for 2 * CO2 cartridges and inflator
- **Size:** 27.2, 30.9, 31.8mm
- **Weight:** 34g / 31.8mm



AQR-21404

- **Spec:** AL6 cold forged with shim for Carbon seat tube clamp
M5 stainless bolt
- **Size:** 31.8 or 34.9mm
- **Weight:** 23g



AQR-21304

- **Spec:** Ultra-light AL7075-T6 CNC with ST bolt seat clamp
- **Size:** 31.8 or 34.9 *H11mm
- **Weight:** 9g / 31.8mm , 10g / 34.9 mm



AQR-21203

- **Spec:** Alloy CNC seat clamp
Multi function with 2*QR light design
100 hour-running time
- **Size:** 31.8 , 34.9 mm
- **Weight:** 32g / 31.8mm, 34g / 34.9 mm

AQR-21203A -- one LED light only



AQR-21205

- **Spec:** UD carbon seat clamp with gap design
- **Size:** 31.8, 34.9 mm
- **Weight:** 12g / 31.8mm, 14g / 34.9mm



AQR-21210

- **Spec:** AL 6061 CNC clamp -- economic type
- **Size:** 28.6, 31.8 , 34.9 mm
- **Weight:** 16g / 31.8mm



AQR-21002

- **Spec:** AL6061 forged double
Seat clamp M4 stainless bolts
- **Size:** 27.2 to 31.8 mm
31.8 to 34.9 mm
- **Weight:** 46g / 27.2 to 31.8mm
34g / 31.8 to 34.9 mm



AQR-2901

- **Spec:** CARBON seat clamp
Cr-Mo bolt with end nut
- **Size:** 31.8 , 34.9mm
- **Weight:** 16g / 34.9mm , 20g / 31.8mm



AQR-2902

- **Spec:** 2-bolt AL6061 forged seat clamp
Strenght reinforced design for Carbon seat tube
- **Size:** 31.8 , 31.6 , 34.9mm
- **Weight:** 29g / 31.8mm



AQR-21104

- **Spec:** Alloy clamp for Cable wire
- **Size:** 28.6, 31.8, 34.9mm
- **Weight:** 17g



AQR-2501

- **Spec:** AL6 cold forged with shim for Carbon seat tube clamp
M5 stainless bolts
- **Size:** 31.8, 34.9mm
- **Weight:** 19g



AQR-21305

- **Spec:** AL 6066 seat clamp within quick release with Ti bolt
- **Size:** 31.8, 34.9 mm
- **Weight:** 21g / 31.8mm, 23g / 34.9 mm



AQR-2305

- **Spec:** AL6 NC machined 1-bolt seat clamp
- **Size:** 28.6, 29.8, 31.8, 34.9mm
- **Weight:** 26g



AQR-21306

- **Spec:** AL7075 CNC seat post clamp with QR
Multi function with 1*QR light design
100 hour-running time
- **Size:** 31.8 , 34.9 mm
- **Weight:** 32g / 31.8mm, 34g / 34.9 mm



AQR-21209

- **Spec:** AL6061 seat clamp within quick release---economic type
- **Size:** 31.8, 34.9 mm
- **Weight:** 48g / 31.8mm, 49g / 34.9 mm



AQR-21211

- **Spec:** AL6061 CNC seat clamp within quick release
- **Size:** 28.6, 31.8, 34.9 mm
- **Weight:** 27.5 g / 31.8mm



AQR-21101

- **Spec:** AL6061-T6 CNC seat clamp with QR lever
- **Size:** 31.8mm or 34.9 x H40mm
- **Weight:** 42g--31.8, 50g--34.9



AQR-2603

- **Spec:** AL6 forged seat clamp with hollowed QR lever
- **Size:** 31.8, 34.9mm
- **Weight:** 39g



AQR-2904

- **Spec:** AL6061 forged QR lever
Long finger specially for comfort bikes
- **Size:** 72mm
- **Weight:** 38g



AQR-2503

- **Spec:** QR lever hollowed design for seat tube
- **Size:** 25mm
- **Weight:** 22g



AQR-21301

- **Spec:** AL6061 QR lever and end nut
Cr-Mo axle
- **Size:** ROAD - F114 X R143 mm
MTB - F114 X R148mm
- **Weight:** 58g / pr



AQR-21302

- **Spec:** Hollow AL6061 QR lever and end nut
Ti axle
- **Size:** ROAD - F114 x R148mm
MTB - F114 x R153mm
- **Weight:** 40g / pr



AQR-21401

- **Spec:** AL6061 QR lever 5-PC set
QR *1, clamp*1, MT-SP 5mm*2pcs,
AL7075 water bottle bolts*4pcs
Cable end*6pcs
- **Size:** ROAD - F114 X R143 mm
MTB - F114 X R148mm



AQR-21402

- **Spec:** AL6061 QR lever 7-PC set
QR *1, clamp*1, MT-SPU 10mm*2pcs,
AL7075 water bottle bolts*4pcs
Cable end*6pcs, valve*2pcs, Expand for stem*1pc,
- **Size:** ROAD - F114 X R143 mm
MTB - F114 X R148mm

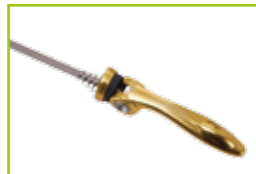

AQR-21307

- **Spec:** AL6061 QR lever and end nut
Cr-Mo flat axle
- **Size:** ROAD - F114 X R143 mm
MTB - F114 X R148mm
- **Weight:** 78g / pr



AQR-21206

- **Spec:** AL7075-T6 CNC QR lever and end nut
Ti M5 axle with Adjustable Wrench 4MM&5MM
- **Size:** ROAD - F100 x R130mm
MTB - F110 x R135mm
- **Weight:** 48g / pr



AQR-2905

- **Spec:** AL6061 QR lever
Cr-Moly axle with position fixer
Specially for Carbon and Hi-End frames
With resin disc brake clips & chain holder
- **Size:** F 100mm R 130 or 135mm
- **Weight:** 178g / set



AQR-21102

- **Spec:** Alloy CNC QR lever and end nut
Cr-Mo axle
- **Size:** ROAD - F100 x R130mm
MTB - F110 x R135mm
- **Weight:** 45g / pr



AQR-2801

- **Spec:** Alloy QR lever and end nut
Ergonomic designed
Hollowed Cr-Moly axle
Fixed Stainless spring
- **Size:** ROAD - F109 x R143mm
MTB - F112 x R148mm
- **Weight:** 90g / pr



AQR-501

- **Spec:** QR set
- **Size:** 110 / 145mm 2pc/set -- for F & R hubs
30 / 110 / 145 mm 3pcs/set --including lever to seat clamp
- **Weight:** 80g / 3pc-set



ASM-21401

- **Spec:** AL7075 3D forged 2-pc stem
- **Angle:** +/-7°
- **Size:** 31.8 x L70~130 x H41 x 28.6mm
- **Weight:** 139g / 90mm

ASM-21401C -- carbon



ASM-21305

- **Spec:** AL6061-T6 Ultra light stem
- **Angle:** +/-6°
- **Size:** 31.8 x L:80 / 90 / 100 / 110 / 120 x 28.6mm
- **Weight:** 110g / 110mm



ASM-21301

- **Spec:** AL6061-T6 3D forged higher range adjustable stem
Hollowed 2-pc 4-bolt clamp
2 Bushing for professional riding
- **Angle:** +/-12° to +/-8°
+/-12° to +/-16°
- **Size:** 31.8 x 70 / 80 / 90 / 100 / 110 / 120 x 28.6
- **Weight:** 166g / 31.8 x 110 x 28.6mm





ASM-21202

- **Spec:** AL6061-T6 CNC Forged stem
- **Angle:** +/-10° H: 40mm
- **Size:** 25.4 / 26.0 / 31.8 x L:90 / 100 / 110 / 120 x 28.6mm
- **Weight:** 152g / 25.4 x 90 x 28.6mm

ASM-21202C -- Carbon fiber wrapped center



ASM-21102

- **Spec:** Super Light AL6061-T6 3D forged ahead stem
Hollowed 2-pc 4-bolt clamp
- **Angle:** +/-7°
- **Size:** 28.6 x 80 / 90 / 100 / 110 / 120 / 130 x 31.8 H:35mm
- **Weight:** 114g / 90mm
106g / 80mm



ASM-2404

- **Spec:** AL6061 3D forged ahead stem
4-bolt clamp
- **Angle:** +/-6° or 35° reversible for MTB / Racing
- **Size:** 28.6 x H40 / 45 x 70 / 80 / 90 / 100 / 110 / 120
- **Barbore:** 25.4, 26.0 or 31.8mm
- **Weight:** 148g / 100mm



ASM-21402

- **Spec:** 3D forged AL6061 2-pc adjustable stem
- **Angle:** -20° ~ + 50°
- **Size:** 25.4 or 31.8 mm x L: 90 or 110 x H41 x 28.6mm
- **Weight:** 251g / 100mm, 31.8mm

To replace ASM-2321, ASM-2607



ASM-21304

- **Spec:** AL6061 CNC 2-pc stem
- **Angle:** 0°
- **Size:** 25.4 or 31.8 x L50 x H50 x 28.6 mm
- **Weight:** 266g / 50mm



ASM-21201

- **Spec:** AL6061-T6 3D forged higher range adjustable stem
Hollowed 2-pc 4-bolt clamp
- **Angle:** -48° to +60°
- **Size:** 25.4 x 90 / 105 x 28.6 H:38mm
31.8 x 90 / 110 x 28.6 H:38mm
- **Weight:** 255g / 31.8 x 90 x 28.6mm



ASM-2607

- **Spec:** Angle adjustable ahead stem
AL6061 melt forged
- **Angle:** 0° to +60°
- **Size:** 28.6 x H40 x Ext.110 / 130 x 25.4mm
- **Weight:** 307g / 110mm

ASM-2617 -- cold forged Ext. 95mm
Weight: 252g



ASM-21104

- **Spec:** AL6061-T6 CNC Forged stem
- **Angle:** 15°
- **Size:** 31.8 x 40 x 28.6 mm
- **Weight:** 200g / 40mm



ASM-21001

- **Spec:** SuperLight AL6066 3D forged & CNC ahead stem
Hollowed 2-pc 4-bolt clamp
- **Angle:** +/-6°
- **Size:** 31.8 x 80 / 90 / 100 / 110 / 120 x 28.6 H:35mm
- **Weight:** 117g / 80mm



ASM-21303

- **Spec:** AL6061-T6 2D forged quill stem
- **Angle:** -20°
- **Size:** 26.0 x 60 / 80 / 100 x 130
- **Weight:** 242g / 60mm



ASM-2703

- **Spec:** AL6061 3D forged ahead stem
2-pc clamp
- **Angle:** +/-7° reversible for MTB / Racing
- **Size:** 25.4 or 31.8 x H41 x 90 / 100 / 110 / 120 x 28.6 mm
- **Weight:** 119g / 90mm



ASM-2606

- **Spec:** Angle adjustable quill stem
AL6061 melt forged
- **Angle:** 0° to +60°
- **Size:** 22.2 / 25.4 x L 180 x Ext.100 / 120 x 25.4mm
- **Weight:** 485g / 100mm



ASM-706

- **Spec:** Alloy post used with a-head stem
- **Size:** Quill 22.2 / 25.4mm
Head 25.4 / 28.6mm
- **Weight:** 180g



ASM-21106

- **Spec:** Alloy Lighter stem adapter
Suitable for Fork ID
25.4 and 24.6 (changing by spacer)
Easy to suit two different fork design
- **Size:** Height:40mm / Length: 116mm
Stem:28.6 (1 1/8")
Spacer 5mm*2, 10mm*2 including
- **Weight:** 154g



ASM-2319

- **Spec:** Alloy forged lock type ahead stem
Adapter with spacers and top cap
- **Size:** 28.6 x L117mm
- **Weight:** 215g



ASM-21403

- **Spec:** CNC & high polished light design spacer
Alloy spacer 3pc/set
- **Size:** 28.6 x 5 / 10 / 15mm
- **Weight:** 3g / 5mm, 5g / 10mm, 8g / 15mm
3mm is not available
Available for one size with 100pcs / bag



ASM-21404

- **Spec:** CNC design spacer
Alloy spacer 4pc / set
- **Size:** 28.6 x 3 / 5 / 8 / 10mm
- **Weight:** 1g / 3mm, 2g / 5mm, 4g / 8mm, 5g / 10mm
Available for one size with 100pcs / bag



ASM-21302

- **Spec:** Super light design
Carbon spacer 3pc/set
- **Size:** 28.6 x 3 / 5 / 10mm or 5 / 10 / 15mm
25.4 x 3 / 5 / 10mm or 5 / 10 / 15mm
- **Weight:** 3g / 5mm, 5g / 10mm, 8g / 15mm
Available for one size with 100pcs / bag



ASM-2710

- **Spec:** Super light design
Alloy spacer 3pc/set
- **Size:** 28.6 x 3 / 5 / 10mm or 5 / 10 / 15mm
- **Weight:** 1g / 5mm
3g / 10mm
Available for one size with 100pcs / bag



ASM-2711

- **Spec:** Super light design
Carbon spacer 3pc / set
- **Size:** 28.6 x 3 / 5 / 10mm or 5 / 10 / 15mm
- **Weight:** 1g / 5mm
2g / 10mm
Available for one size with 100pcs / bag



ASM-21101

- **Spec:** Alloy Top cap with special laser drawing design
Stainless Star washer
- **Size:** 28.6 or 25.4mm
- **Weight:** 26g / pc



ASM-2002

- **Spec:** Top cap for ahead type
Alloy with ST star nut M6 bolt
- **Size:** 28.6 or 25.4mm
- **Weight:** 27g / pc



ASM-2609

- **Spec:** Alloy top cap with CNC nut for Carbon steerer tube
- **Size:** 1" x ID19-23mm
1-1/8" x ID22-26mm
- **Weight:** 39g



ASM-21203

- **Spec:** Top cap for ahead type
AL6061-T6 with CNC star nut
- **Size:** 28.6 or 25.4mm
- **Weight:** 20g / pc



ASM-21204

- **Spec:** Top cap for ahead type
AL6061-T6 with CNC star nut
For carbon steerer tube
- **Size:** 28.6 or 25.4mm
- **Weight:** 30g / pc



ASM-2406

- **Spec:** Alloy Top cap with CARBON fabric with star nut
- **Size:** 28.6 / 25.4mm or 25.4 / 22.2mm
- **Weight:** 26g



ABG-21108

- **Spec:** WHEEL BAG
1200D Tetolon within watherproof
Two wheels in one bag with protector
- **Size:** 33" x 3-3/4" x 27-1/2"
- **Weight:** 1100g



ABG-2803

- **Spec:** Shopping bag for ABK-2701 baseket
600D Polyester with recyclable PU backing
Nylon cover with tie strap & webbing shoulder straps
- **Size:** Expendable 28 / 50 x 17 x 22 / 42cm
- **Weight:** 300g



ABG-21104

- **Spec:** Bike bag suitable with seat post carrier
1680D Nylon PU backing
Including QR rear carrier, raincoat for bag
- **Size:** 208 x 120 x 180mm
- **Weight:** 390g



ABG-21105

- **Spec:** Business bike bag
1680D Nylon PU backing
Suitable with ACR-21103
Including detachable shoulder strap, pen bag, raincoat for bag
- **Size:** 380 x 305 x 115mm
- **Weight:** 940g



ABG-21003

- **Spec:** 70D BIKE COVER
Suitable for 650~700C
- **Size:** 70" x 26.5" x 46"
Folding size: 8" x 3" x 5.5"
- **Weight:** 220g



ABG-21103

- **Spec:** Multi-compartment bike bag
1680D Nylon PU backing
For light touring and commuting to work or school
2-side pocket expanded
- **Size:** 355 x 254 x 190mm
- **Weight:** 1078g



ABG-21205

- **Spec:** Sleek & practical Rear Carrier bag
Durable cambric material w/adjustable shoulder strap
With detachable inner zip pocket
Fully padded back panel for cushioning comfort
Easy assemble and fixed on the carrier
- **Size:** 320 x 250 x 120mm
- **Weight:** 980g



ABG-2901

- **Spec:** Multi-function bike bag
1800D Nylon PU backing
With bracket QRB for handlebar
Shoulder strap for easy carry
Base velcro strap for rear carrier
- **Size:** 32 x 20 x 22cm
- **Weight:** 1490g



ABG-21206

- **Spec:** Multi-compartment bike bag
2520D Nylon PU backing
Max loading 5 kg
With raincover
- **Size:** 330 x 260 x 220mm for standard
330 x 350 x 390mm for 2-side pocket expanded
- **Option:** with QR seat post carrier and fender or without QR
- **Weight:** 1585g for normal standard size without QR



ABG-2804

- **Spec:** TOURING bag
Water resistance 600D Polyester
Recyclable PU backing
Nylon injection bracket for rear carrier
3M reflector
- **Size:** 31 x 15 x 30cm
- **Weight:** 1712g / set



ABG-21001

- **Spec:** Nylon bag for Sun Glasses with hold lock
- **Weight:** 32g
- **Option:** Neoprene



ABG-21207

- **Spec:** ABS+TPU saddle bag with Anti-warter zip
EVA inside and plastic cover
Ultra weight and waterproof design
- **Size:** S 155 x 95 x 95mm
M 160 x 110 x 110mm
L 175 x 130 x 125mm
- **Weight:** 147g



ABG-2704

- **Spec:** Saddle bag
Water resistance 1680D Polyester PU coated
Safety 3M reflector and Green webbing trimming
Expendable gusset designed
 - **Size:** L - 105 x 170 x 90 / 150mm
S - 90 x 139 x 80 / 130mm
 - **Weight:** 192g--L
- To replace ABG-2501**



ABG-2902

- **Spec:** Handlebar bottle bag
1800D Nylon Neoprene backing
Adjustable locking tie
With QR bracket handlebar 22.2 to 27.5mm
- **Size:** 76 x 115mm
- **Weight:** 73g



ABG-21002

- **Spec:** 1680D Nylon fabric with PU saddle bag
2 side fashion design, water resistant,
Safety 3M reflector trimming
- **Size:** 170 x 85 x 90mm
- **Weight:** 90g



ABG-21208

- **Spec:** ABS+TPU saddle bag with Anti-warter zip
2520D 2-side pocket expanded design
- **Size:** 185 x 190 x 130mm
- **Weight:** 366g



ABG-2705

- **Spec:** Mini Saddle bag
Water resistance 1680D Polyester PU coated
Safety 3M reflector and Green webbing trimming
- **Size:** 82 x 124 x 63mm
- **Weight:** 123g

To replace ABG-401



ABG-2707

- **Spec:** Bull shape saddle bag
Water resistance 1680D Polyester PU coated
Safety 3M reflector trimming
- **Size:** L - 94 x 185 x 102mm
S - 75 x 175 x 90mm
- **Weight:** 137g -- L



ABG-21301

- **Spec:** Phone bag with revolving platform
W/ABS QR BRACKET 22.2mm-32mm
- **Size:** 120 x 20 x 70mm
- **Weight:** 87g including QR bracket



ABG-2706

- **Spec:** EVA saddle bag
Water resistance 1680D Polyester with EVA inner
Safety 3M reflector trimming
- **Size:** 107 x 142 x 75mm
- **Weight:** 138g

To replace ABG-2503



ABG-21209

- **Spec:** ABS+PVC cellphone bag with Anti-warter zip
Trans.PVC cover to easy touch screen
Elastic inside to suitable in the general size mobile phone
With bracket
- **Size:** 150 x 100 x 70mm
- **Weight:** 158g



ABG-21106

- **Spec:** 2 way Handlebar-Fanny bag
1680D Nylon PU backing with 420D PVC
With Cell phone bag stretched-out design
- **Size:** 100 x 45 x 150mm (in handle bar)
- **Weight:** 330g





ABG-21203

- **Spec:** Handdle bar bag
1000D watherproof Tarpaulin Leather cover
Handy pockets within Velcro
With detachable & adjustable across body strap
- **Option color:** Black, white, grey, blue, green
- **Size:** 250 x 100 x 80mm
- **Weight:** 289g

ABG-21204 -- with cambric material



ABG-21210

- **Spec:** ABS with 2520D water resistant Nylon backpack
Release friction between back and bag
Ultra weight with heat insulation
And ventilation net support
Easy to assemble 2000c.c. water bladder
- **Size:** 300 x 95 x 450mm
- **Weight:** 888g



ABK-21302

- **Spec:** Plastic rear basket with handle bar
QR design
- **Size:** W400 x D300 x H200mm
- **Weight:** 1320g



ABK-21303

- **Spec:** Alloy rear basket with handle bar
QR design
- **Size:** W400 x D300 x H170 / 135mm
- **Weight:** 1190g



ABG-21202

- **Spec:** Sleek, lightweight and durable Post bag
1000D watherproof Tarpaulin Leather cover
Oversized pocket
With detachable inner pocket and cellphone bag
- **Size:** 500 x 300 x 200mm
- **Weight:** 1146g



ABK-21401

- **Spec:** P.P. front basket with double color injection
- **Size:** Fit to 16"-18" kids bike
- **Weight:** 309g



ABK-21402

- **Spec:** P.P front basket with QR adaptor
QR is fit to ϕ 22.2~31.8mm handle bar
- **Size:** W389 x D297 x H260mm
- **Weight:** 1052g with QR
788g w/o QR



ABK-21403

- **Spec:** P.P rear basket
- **Size:** W440 x D370 x H250mm
- **Weight:** 1360g



ABK-21301

- **Spec:** Alloy rear basket with foam bar
QR design
- **Size:** W410 x D300 x H200mm
- **Weight:** 1470g



ABK-21304

- **Spec:** Plastic front basket with handle bar
With bracket
- **Size:** W350 x D260 x H250 / 220mm
- **Weight:** 1120g (with bracket)



ABK-21201

- **Spec:** Alloy basket with wood base and foam bar
With bracket
- **Size:** W370 / 320 x D250 / 215 x H260mm
- **Weight:** 870g (with bracket)



ABK-21202

- **Spec:** Alloy basket with wood base and foam bar With bracket
- **Size:** W370 / 309 x D238 / 153 x H195mm
- **Weight:** 670g (with bracket)



ABK-21203

- **Spec:** Alloy basket with foam bar With bracket
- **Size:** W375 / 325 x D235 / 185 x H195mm
- **Weight:** 680g (with bracket)



ABK-21101

- **Spec:** Steel basket with shopping bag With QR type bracket and bike cover
- **Size:** W345 x D255 x H250mm
- **Weight:** 1005g (w/o bracket)



ABK-2701

- **Spec:** Willow weaved basket clear coated With handle bar mounting clamp Stainless plate fit with QRB type bracket Capacity 15kgs
- **Size:** W380 x D280 x H265mm
- **Weight:** 1250g



ABE-21401

- **Spec:** Alloy Twist bell Macaron serious
- **Size:** 83mm For 22.2mm handle bar
- **Weight:** 32g



ABE-21402

- **Spec:** Mini copper bell with plastic base save space design
- **Size:** 23mm For 19.2~31.8mm handle bar
- **Weight:** 28g



ABE-21403

- **Spec:** Alloy bell with plastic base 360° revolve mirror design
- **Size:** 53mm For 22.2mm handle bar
- **Weight:** 45g



ABE-21404

- **Spec:** Mini copper bell with alloy CNC accessories For brake lever
- **Size:** 23mm For 19.2~31.8mm handle bar
- **Weight:** 19g



ABE-21302

- **Spec:** Spacer Bell
- **Size:** 28.6 x 10mm
- **Weight:** 41g



ABE-21304

- **Spec:** Mini Bell Brass top with plastic strap
- **Size:** 23mm For 19.2~31.8mm handle bar
- **Weight:** 19g



ABE-21301

- **Spec:** Ding Dong bell For cruiser or city bike
- **Size:** 83mm For 22.2mm handle bar
- **Weight:** 279g



ABE-21303

- **Spec:** Animal design Bell with plastic base
- **Size:** 55mm For 22.2mm handle bar
- **Weight:** 50g



ABE-21201

- **Spec:** Transparent bell cap
Clear sound by both turn left and right
- **Size:** For 22.2mm handle bar
- **Weight:** 37g



ABE-21202

- **Spec:** Capsule Bell
Quick release design
- **Size:** For 22.2mm handle bar
- **Weight:** 33g



ABE-21101

- **Spec:** Alloy top with plastic base
- **Size:** With easy adjustable strape for handle bar Ø22.2~31.8
- **Weight:** 25g



ABE-21205

- **Spec:** Dices Bell with alloy top and plastic base
- **Size:** For 22.2mm handle bar
- **Weight:** 42g



ABE-21206

- **Spec:** Alloy Light Bell
Small size 38mm with 360° rotating LED light
- **Size:** For 22.2mm handle bar
- **Weight:** 41g



ABE-21207

- **Spec:** Basketball Bell
Alloy top with plastic base
- **Size:** For 22.2mm handle bar
- **Weight:** 36g



ABE-21203

- **Spec:** Compass Bell with plastic base
- **Size:** For 22.2mm handle bar
- **Weight:** 36g



ABE-2904

- **Spec:** Glitter bell
6 colorful LED
Ø43mm top cap
- **Size:** For 22.2mm handle bar
- **Weight:** 60g / pc
- **Option:** Box of 12 mixed blue and pink



ABE-21102

- **Spec:** YoYo Bell-Special material top with plastic base and lever
With Automatic, manual operation mode
Automatic is safer for child
- **Size:** For 22.2mm handle bar
- **Weight:** 50g



ABE-2802

- **Spec:** Football knocking bell
Alloy top
- **Size:** For 22.2mm handle bar
- **Weight:** 29g
- Available for one box within 20pcs/box



ABE-2803

- **Spec:** Coffee knocking bell
Alloy top
- **Size:** For 22.2mm handle bar
- **Weight:** 29g
- Available for one box within 20pcs/box



ABE-2807

- **Spec:** Knocking bell
Detachable and flexible tie bracket
- **Size:** For 22 to 31.8mm handle bar
- **Weight:** 22g

To replace ABE-2601
Available for one box within 20pcs/box



ABE-2201

- **Spec:** Ladybug knocking bell
With plastic wings
- **Size:** For 22mm handle bar
- **Weight:** 32g

Available for one box within 10pcs/box



ABE-2401

- **Spec:** AL top with ergonomic lever
- **Size:** For 22mm handle bar
- **Weight:** 26g

Available for one box within 20pcs/box



ABE-2101

- **Spec:** Kids knocking bell
AL cartoon picture (frog or pig) cap
- **Size:** For 22mm handle bar
- **Weight:** 20g

Available for one box within 20pcs/box

AWS-21301

- **Spec:** Light weight Anti-Rust Racing Stand
Easily assembling without any tools
Carry convenient design
Suitable for 2-3 bikes and max. 100kg
- **Size:** 35mm x 1.2M
2pcs A shape stand, 1pc bar, and a carry bag.
- **Weight:** 4kg



AWS-21401

- **Spec:** L type alloy display stand
With anti-scratch protectors
Folding & light way for easy carry design
- **Size:** Fitted for 20"-28"
- **Weight:** 828g



AWS-21101

- **Spec:** Enhanced & Adjust
"L" shape alloy display stand
- **Size:** Fitted for bike from 18" to 28"
- **Weight:** 1580g



AWS-2801

- **Spec:** AL6061-T6 plate
3-pc folding type
Anti-rust fitting kits
Anti-scrub rubber protector
Neoprene carry bag
Folded size: L245 x W64 x H25mm
Unfold size: L245 x W64 x H270mm
- **Size:** Fitted for 26", 28" or 700C bikes
- **Weight:** 450g



AWS-2503

- **Spec:** Hi-Ten L type bike stand
With anti-scratch protectors
- **Size:** Fitted for 24" & 26"
- **Weight:** 2344g



AWS-2502

- **Spec:** Hi-Ten bike stand for rear hub
With QR lever
- **Weight:** 815g



AWS-2701

- **Spec:** Maintenance Stand
Hollowed ST tubing
Fit to bikes with or without RD
- **Weight:** 757g



AWS-2501

- **Spec:** Hi-Ten wall type bike holder
With anti-rust screws
- **Weight:** 608g



AWS-2901

- **Spec:** 2-Bike holder
Straight up for Alloy tubing Ti-finish coated
Position adjustable plastic bike holder
- **Size:** 330 or 400cm
- **Weight:** 6kg--330cm



ABP-2701

- **Spec:** ECO-Bike protector for travel convenience
Re-use& durable design
Max.loading :30kg
- **Size:** 1150mm x 810mm x 305mm x 5mm
- **Weight:** 3,300g

**ABP-21201, smaller size with
1060mm x 740mm x 230mm x 5mm**



ABP-21101

- **Spec:** ECO-Trolley wheels for travel convenience
Instant Mobility ssystem
Re-use, quick release,
360° rotatable rollers& light weight design
Single wheel Max.strength: 297kg
Velcro Max.strength:80kg
- **Size:** 2sets of 250cm Velcro straps with 4 trolley wheels
With storage bag as protective glove for wheel release
- **Weight:** 935g / set



AWB-21401

- **Spec:** Candy color bottle
Food grade LDPE injection
With spray nozzle design
Without Dustproof cover
- **Size:** 750cc
- **Weight:** 80g



AWB-21402

- **Spec:** Child bottle
Food grade LDPE injection
- **Size:** 350cc
- **Weight:** 54g



AWB-21301

- **Spec:** Bullet design bottle
Food grade LDPE injection
Dustproof cover
- **Size:** 800cc-L , 600cc-M
- **Weight:** 75g--800cc
68g--600cc

AWB-21301P -- PP bottle



AWB-21201

- **Spec:** Thermos bottle
Food grade LDPE injection
Groove for easier grip design
Dustproof cover
Thermal function available for 2hrs
- **Size:** 500cc
- **Weight:** 136g



AWB-21001

- **Spec:** Food grade LDPE injection
Groove for easier grip design
Dustproof cover
- **Size:** L --800cc
M--550cc
- **Weight:** 61g--M



AWB-21202

- **Spec:** Double density bottle
Food grade LDPE injection
Non-slip for easier grip design
With natural rubber to anti-allergy
Dustproof cover
- **Size:** 750cc
- **Weight:** 102g



AWB-2803

- **Spec:** THERMO LDPE injection
Double layer body
Available for ice and hot water
- **Size:** 450c.c.
- **Weight:** 148g



AWB-2901

- **Spec:** LDPE injection
Bite-to-suck cap design
Available for hot water upto 70°
Dustproof cover
- **Size:** 700cc
- **Weight:** 72g

To replace AWB-2402 & AWB-2701



AWB-2703

- **Spec:** PC water bottle
Available for hot water upto 120°
With dust-free transparent cap
- **Size:** 600c.c
- **Weight:** 58g



ABC-21401

- **Spec:** Plastic bottle cage
Macaroon serious
- **Size:** Max.bottle dia 76mm
- **Weight:** 30g



ABC-21404

- **Spec:** Plastic bottle cage
With closed type in front side
- **Size:** Max.bottle dia 76mm
- **Weight:** 29g

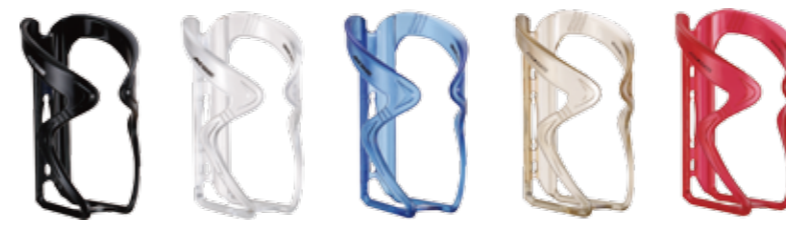

ABC-21103

- **Spec:** Plastic bottle cage
Clasp design
- **Size:** Max.bottle dia 76mm
- **Weight:** 48g



ABC-21302

- **Spec:** 3K carbon fiber bottle cage
- **Size:** Max.bottle dia 76mm
- **Weight:** 27g

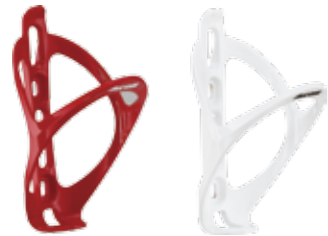

ABC-21405

- **Spec:** Plastic bottle cage
- **Size:** Max.bottle dia 76mm
- **Weight:** 30g



ABC-21303

- **Spec:** Plastic bottle cage
Special shape for release pressure
- **Size:** Max.bottle dia 76mm
- **Weight:** 35g



ABC-2901

- **Spec:** Nylon fiber bottle cage
- **Size:** Durable for bottle with wide diameter
- **Weight:** 37g



ABC-21402

- **Spec:** Stainless bottle cage
X type design
- **Size:** Max.bottle dia 76mm
- **Weight:** 52g



ABC-21304

- **Spec:** Plastic bottle cage
TPE design for micro adjustable
- **Size:** Max.bottle dia 76mm
- **Weight:** 26g



ABC-21406

- **Spec:** Ultra- light Alloy bottle cage
With TPE design for micro adjustable
- **Size:** Max.bottle dia 76mm
- **Weight:** 32g



ABC-21403

- **Spec:** Stainless bottle cage
Expandable design
- **Size:** Max.bottle dia 76mm
- **Weight:** 70g



ABC-21204

- **Spec:** Plastic bottle cage
Extend open design at backside
- **Size:** Max.bottle dia 76mm
- **Weight:** 28g



ABC-21301

- **Spec:** Alloy bottle cage
One-piece Up side direction design with 4.3mm tubing
 - **Size:** Max.bottle dia 76mm
 - **Weight:** 29g
- To replace ABC-2702



ABC-21305

- **Spec:** Alloy bottle cage X type
One-piece Up side direction design with 4.3mm tubing
- **Size:** Max.bottle dia 76mm
- **Weight:** 31g



ABC-21306

- **Spec:** Alloy bottle cage
One-piece Up-right side direction design
With 4.3mm tubing
 - **Size:** Max.bottle dia 76mm
 - **Weight:** 32g
- To replace ABC-2505



ABC-21106

- **Spec:** Alloy bottle cage
- **Size:** Max.bottle dia 76mm
Option strap: BK/White, BK/Red, BK/Blue
- **Weight:** 98g

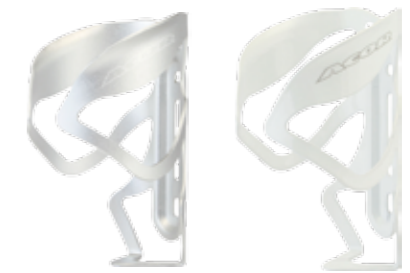

ABC-21005

- **Spec:** Alloy bottle cage - 3D forging
Front -open hollowed design
- **Size:** Max.bottle dia 76mm
- **Weight:** 40g



ABC-21205

- **Spec:** Alloy bottle cage
1.2mm thickness Ultra light design
With rubber part to more extension
- **Size:** Max.bottle dia 76mm
- **Weight:** 26g



ABC-21201

- **Spec:** Alloy bottle cage without welding construction
Suitable for small dia.bottles
(drinking bottles and mineral water bottles)
- **Size:** Max.bottle dia 64~66mm
- **Weight:** 34g



ABC-2904

- **Spec:** Alloy bottle cage
Suitable for right hand and left hand users
Suitable for narrow bike frame
- **Size:** Max.bottle dia 76mm
- **Weight:** 43g



ABC-2302

- **Spec:** AL 5mm tubing
Finger hold design w/plastic plugs
- **Size:** Max.bottle dia 76mm



ABC-21202

- **Spec:** Alloy bottle cage
Up-right side direction design
- **Size:** Suitable for narrow bike frame
- **Weight:** 32g



ABC-21104

- **Spec:** Alloy bottle cage
Stagger design with holder
- **Size:** Max.bottle dia 76mm
- **Weight:** 60g



ABC-2101

- **Spec:** AL 6mm tubing
Side-off design
- **Size:** Max.bottle dia 76mm
- **Weight:** 63g



ABC-2001N

- **Spec:** AL 6mm tubing
W/ plastic plugs
- **Size:** Max.bottle dia 76mm
- **Weight:** 63g



ABC-21307

- **Spec:** Alloy cage adapter
For existing bottle cage to use
- **Size:** For handle bar dia 25.4 to 31.8mm
- **Weight:** 63g



ABC-21206

- **Spec:** Alloy cage adapter
For existing bottle cage to use
- **Size:** For handle bar dia 22.2 to 25.4mm
- **Weight:** 39g



ABC-21207

- **Spec:** Alloy cage adapter
For existing bottle cage to use
M5*12mm Steel bolts *2 + M5*30mm Stainless bot *1
- **Size:** For handle bar dia 25.4 to 31.8mm
- **Weight:** 40g



ABC-21107

- **Spec:** Alloy bottle cage holder
- **Size:** Assemble with rail of saddle
- **Weight:** 122g



ABC-21407

- **Spec:** AL7075 CNC bolts for bottle cage
- **Size:** 4pc / set
- **Weight:** 4g / set



ABC-21408

- **Spec:** AL6061 bolts for bottle cage
- **Size:** 4pc / set
- **Weight:** 4g / set



ABC-2801

- **Spec:** Resin bottle cage bracket
Rotatable for seat post and handlebar
Stainless Steel clip
- **Size:** S- for tube dia 19.0-22.2mm
M- for tube dia 22.2-25.4mm
L- for tube dia 28.6-31.8mm
- **Weight:** 34g



ACR-21103

- **Spec:** AL Multi-Function Seat post rear carrier
3-mode folding design
With reflector plate
Max loading 10kg
- **Size:** For seat post 25.4~32mm
- **Weight:** 1060g



ACR-2401

- **Spec:** MTB rear carrier
Angle adjustable AL clamp
Plastic top plate with reflector and spring strape
Max loading 10kg
- **Size:** For seat post 25.4~32mm
- **Weight:** 600g



ACR-21401

- **Spec:** Saddle rail post Rear carrier
For CO2 cartridge*2 + inflator*1
Water bottle*2+inner tube*1
- **Size:** With 34cm Velcro strap
- **Weight:** 178g



ACR-21104

- **Spec:** AL Multi-Function Seat post rear carrier
With 3-mode 5LED tail light funtion
Could be like a fender.Max loading 10kg
- **Size:** For seat post 25.4~32mm
- **Weight:** 722g



ACR-21301

- **Spec:** AL6061 DIY luggage carrier
Ultra weight design, including seat clamp
- **Size:** Adjustable for 26"- 28" bike
- **Weight:** 320g



ACR-21302

- **Spec:** AL front carrier
With wood plate
 - **Weight:** 1220g
- NOT available for Japen market*



ACR-2101

- **Spec:** Light alloy low rider pannier rack carrier
With bracket fit onto front fork blades
- **Weight:** 567g



ACR-21402

- **Spec:** AL die cast rear carrier
With steel spring clip, reflector plate
- **Size:** adjustable for 26"-29" bike
- **Weight:** 806g



ACR-21303

- **Spec:** Cr-Mo rear carrier
With ST spring clamp and reflector plate
Max. loading with 40kg
- **Size:** Adjustable for 26"-28" bike
- **Weight:** 980g



ACR-21201

- **Spec:** AL tig welded rear carrier with invisible screw design
Triangle tubing for better strength effect
With spring clamp and reflector plate
- **Size:** Adjustable for 26"-28" bike
- **Weight:** 734g



ACR-21202

- **Spec:** AL rear carrier with die case 1-pc frame
Two stays design
With spring clamp and reflector plate
- **Size:** Adjustable for 24"-28" bike
- **Weight:** 822g



ACR-21204

- **Spec:** AL rear carrier with tie welded
Triangle tubing design
With spring clamp and reflector plate
- **Size:** Adjustable for 26"-28" bike
- **Weight:** 650g



ACR-21102

- **Spec:** AL rear carrier with Curve shape protector
Fit mudguard design
With spring clamp and reflector plate
- **Size:** Adjustable for 26"-28" bike
- **Weight:** 552g



ACR-2506

- **Spec:** AL 9.6mm hollowed tubing rear carrier
With spring clamp and reflector bracket
 - **Size:** Adjustable for 26"-28" bikes
 - **Weight:** 725g
- To replace ACR-502*



ACC-2701

- **Spec:** Chain guide for Trial or Dual Slalon
AL6061 CNC machined with single roller
- **Size:** Compatible to double chainring 22/32T
- **Weight:** 130g



ACC-2601

- **Spec:** AL press chain guide 1-roller
13mm thickness CNC removable rocking
- **Size:** Available for 38 to 44T
- **Weight:** 800g



ACC-2901

- **Spec:** Hi-Ten & AL6061 CNC machined arm
For Dual-Slalon bikes
One-Sealed-Bearing roller
- **Size:** For 2-pc chainring 22/32T
- **Weight:** 297g



ACC-21001

- **Spec:** Tension for Changing chain to single speed
- **Size:** C-C:51 for 16-18T (common spec)
C-C:34 for 12-14T
- **Weight:** 122g / set --16-18T



ACC-2602

- **Spec:** PC injection chain guard
Crank to chainring distance 6 to 16mm
- **Size:** 42 & 44T or 46 & 48T
- **Weight:** 82g--42 & 44T



AFD-2504

- **Spec:** PC extrusion mudguard F+R
Stainless steel V-stays anti-rust bolts
- **Size:** W35mm for 700 x 25-32C
- **Weight:** 413g



AFD-2506

- **Spec:** PC extrusion mudguard F+R
Stainless steel stays anti-rust bolts
- **Size:** W45mm for 700 x 32-40C
- **Weight:** 500g



ACC-2902

- **Spec:** AL7075 CNC machined
For single speed
Hard Anodized finish
5-arm Teeth: 45-55T
- **Size:** BCD 144 (Campy compatible) or 130mm
- **Weight:** 74g / 130 x 45T
78g / 144 x 50T



ACM-21101

- **Spec:** 7-Function cycle computer for Entry-level
Easy Reading design
SPD, AVS, Time, Distance, Odometer, SPD comparison, Clock
With 1 x CR2032 battery
- **Size:** 32 x 52 x 17 mm
- **Weight:** 18g

ACM-21101A -- Wireless with 12-Function / 20g
Max.SP, Dual Wheel size, calorie, ODO1&ODO2, backlight



AFD-21401

- **Spec:** Mudguard F+R PC injection
Revolutionary folding design
Tough and durable
- **Size:** 22"~26"
- **Weight:** 226g (F+R+Bracket)



AFD-21402

- **Spec:** Mudguard F+R PC injection
35° angle adjustable for rear
Tool - free rear clamp
45mm bridge length adjustable
- **Size:** 24"~26"
- **Weight:** 185g (F+Bracket)
90g (R+Bracket)



ACM-21102

- **Spec:** 9-Function cycle computer for Wireless entry-level
SPD, AVS, Max.SP, SPD comparison,
Time, Distance, totalOdometer, Clock, Dual Wheel size
With 1 x CR2032 battery
- **Size:** 48 x 42 x 12 mm
- **Weight:** 24g



AFD-2503

- **Spec:** Mudguard F+R PC injection
For assemble with fork blades and rear seat stays
Stainless stays anti-rust bolts
- **Size:** For 700 x 25C
- **Weight:** 407g



AFD-21101F/R

- **Spec:** PP/TPR injection mudguard and Carbon sticker fender
Front: For Down tube using
Rear: Easy installation design
- **Size:** Front: Suitable for all bike
Rear: For 24"~26" bike
- **Weight:** F: 58g, R : 248g



AFD-21001

- **Spec:** 20" Folding Bike S.T.P.P. injection mudguard
With additional alloy strap to increase more reflection
Easy installation
- **Size:** For 20" folding bike
- **Weight:** 96g



AFD-21002

- **Spec:** PP injection mudguard With 2 size bracket Ø32-36 & Ø28-32 Length adjustable + 33mm
- **Size:** For 24", 26", 700C, 28" bikes
- **Weight:** 172g

To replace AFD-2404



AFD-2501F/R

- **Spec:** MTB front fender PP injection F+R Suitable with 1" or 1-1/8" steerer tube With easy-mount and angle adjustable bracket
- **Size:** For 24" & 26" tire
- **Weight:** F.: 136g, R.: 172g

AFD-21202

- **Spec:** Mudguard F+R PP injection For assemble with fork blades and rear seat stays Front with 3M reflector Rear with ECO RED LED light w/1*CR2032 battery Only 1 LED input and get the Max.light power like 8 LED Through the light guard Light continuously on: approx. 160 hrs
- **Size:** 20" to 700C for tire 1.25"~1.75"
- **Weight:** F.: 36g, R.: 72g

AFD-21202A : Adjust the best angle w/o tool for Quick release clamp on seat post



AFD-21003

- **Spec:** 2 limid Line PP injection lightweight mudguard F+R Easy angle adjustable w/o tools for rear fender
- **Size:** For 24" or 26" bikes
- **Weight:** F.: 157g, R.: 246g



AFD-21201R

- **Spec:** Racing Mudguard Rear PP injection AL6061 Mono-stay with compact shape CNC knob and forged interface V-shape inner ribs design with efficiently leads tires water flow From tangent to lateral direction Can be assembled with any QR Any smart phone can setup the angle for first time use
- **Size:** For 700C, tire with 20-25mm
- **Weight:** 78g / set



AFD-2403

- **Spec:** PP injection easy assembly with velcro
- **Size:** For MTB down tube
- **Weight:** 77g



AFD-2502R

- **Spec:** Road PP injection rear fender With easy-mount and angle adjustable bracket
- **Size:** For 23C tire
- **Weight:** 135g



AFW-21001

- **Spec:** AL7075 freewheel For single speed cassette-type hub
- **Size:** 14 / 16 / 18T
- **Weight:** 17g / 14T

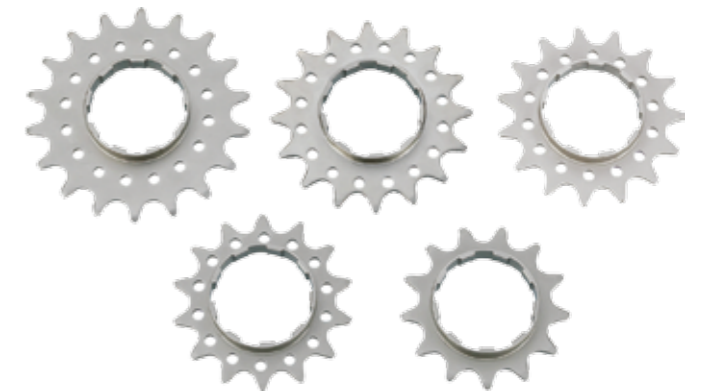

AFW-2902

- **Spec:** Cr-Moly heat treated freewheel For single speed cassette-type hub Height: 7mm
- **Size:** 13 / 14 / 15 / 16 / 17 or 18T
- **Weight:** 32g / 16T

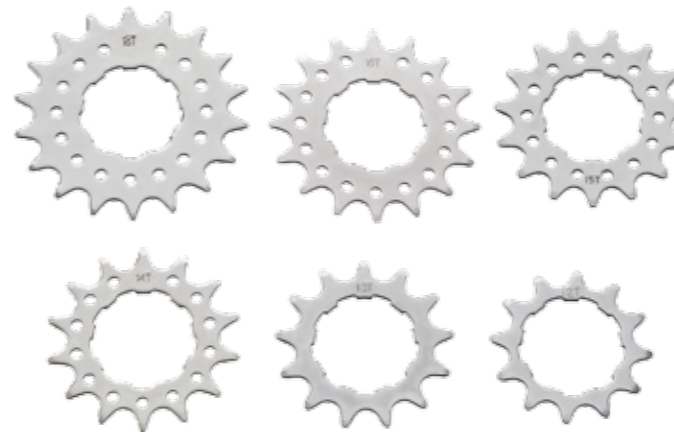

AFW-2901

- **Spec:** Cr-Moly heat treated freewheel For single speed bike
- **Size:** 12 / 13 / 14 / 15 / 16 / 17 or 18T
- **Weight:** 28g / 16T



ARB-2801

- **Spec:** Nylon tire tape Micro elasticity perfectly fit with rims Afford high pressure upto 180psi
- **Size:** MTB - 26" x 18 or 22mm (L85mm) Road - 700C x 16mm (L95mm)
- **Weight:** 112g / pr



ATI-2901

- **Spec:** MTB inner tube with Removable Presta valve 38mm or 48mm
- **Size:** 26" x 1.25"
26" x 1.5-1.75"
26" x 1.9-2.125"



ATI-2902

- **Spec:** ROAD inner tube with Removable Presta valve 38mm or 48mm
- **Size:** 700 x 23-25C
700 x 28-32C



ATI-21001

- **Spec:** Recycling Tube for Presta valve
Easy Repaired by lighter
Safety- Still work available for few hours after broken
- **Size:** 20" or 26" or 700C



AKS-21401

- **Spec:** Alloy quick release rear kickstand
Length is adjustable Patented design
Tool free & No need to be fixed on frame tube
- **Size:** For 24"-29" bikes
- **Weight:** 220g



AKS-21407

- **Spec:** Alloy rear kickstand
Adjust the length w/o tool, QR design
Fit to various dimension tubes
- **Size:** For 24"-29" bikes
- **Weight:** 320g



AKS-21409

- **Spec:** Alloy rear kickstand
Adjust the length w/o tool, QR design
- **Size:** For 24"-29" bikes
- **Weight:** 376g



AKS-21304

- **Spec:** Alloy rear kickstand
Adjust the length without tool
- **Size:** For 24"-28" bikes or 26"-29" bikes
- **Weight:** 274g



AKS-21306

- **Spec:** Alloy rear kickstand
Length is adjustable
- **Size:** For 26"-700C bikes
- **Weight:** 355g



AKS-21402

- **Spec:** Alloy rear kickstand
Length is adjustable
Patented design For various dimension tubes
- **Size:** For 24"-29" bikes
- **Weight:** 355g



AKS-21404

- **Spec:** Alloy rear kickstand
Adjust the length with tool
With rubber for various dimension tubes
- **Size:** For 26"-28" bikes
- **Weight:** 334g



AKS-21201

- **Spec:** Alloy rear kickstand
Easy fixed with 3 screws
Fits on 45° to 65° of different dia. of seat stay and chain stay
 - **Size:** For 24"-28" bikes
 - **Weight:** 354g
- To replace AKS-2602 & AKS-2501**



AKS-2001

- **Spec:** Alloy rear wide angle type kickstand
With adjustable length
- **Size:** For 24"-28" bikes
- **Weight:** 339g



AKS-21405

- **Spec:** Alloy center kickstand
Adjust the length without tool, QR design
With alloy top plate
- **Size:** For 26"-29" bikes
- **Weight:** 300g



AKS-21406

- **Spec:** Alloy center kickstand
Adjust the length without tool, QR design
With alloy top plate
- **Size:** For 26"-29" bikes
- **Weight:** 375g



AKS-21408

- **Spec:** Alloy center kickstand
Adjust the length w/o tool, QR design
With steel top plate
- **Size:** For 24"-29" bikes
- **Weight:** 264g



AKS-21301

- **Spec:** Alloy center kickstand
Larger angle 340mm
- **Size:** For 24"-28" bikes
- **Weight:** 400g



AKS-21302

- **Spec:** Alloy center kickstand
Adjust the length without tool
- **Size:** For 24"-29" bikes
- **Weight:** 300g



AKS-21305

- **Spec:** Alloy center kickstand
Length is adjustable
- **Size:** For 24"-28" bikes
- **Weight:** 195g



AKS-2801

- **Spec:** Center kickstand
Alloy diecast head part
Nut type adjustable lower blade
- **Size:** For 24"-28" bikes
- **Weight:** 246g



AKS-21303

- **Spec:** Alloy bottom leg kickstand
Compatible with Shimano Hollowtech2 & TRUVATIV
Giga Pipe (BB cup 44mm)
- **Size:** For 24"-28" bikes
- **Weight:** 164g



AKS-2403

- **Spec:** Center kickstand
AL adjustable
- **Size:** For 24"-28" bikes
- **Weight:** 210g



AKS-21403

- **Spec:** Alloy center 2-Leg kickstand
Adjust the length without tool, QR design
With alloy top plate
- **Size:** For 26"-29" bikes
- **Weight:** 468g



AKS-2902

- **Spec:** Center 2-Leg kickstand
Alloy adjustable.
The angle can turned to 35°
Length lower blade by M4 Allen key
- **Size:** For 26"-28" bikes
- **Weight:** 256g



AKS-2502

- **Spec:** Center 2-Leg kickstand
AL Double-leg type
- **Size:** For 26"-28" bikes
- **Weight:** 546g



ALT-21108

- **Spec:** Multi AL6061-T6 CNC Bracket
For front light, computer, accessories
- **Weight:** 30g



ALT-21001

- **Spec:** Handlebar Capacity Organizer
Bracket only
Can set head light / speedmeter / accessories
- **Weight:** 32g



ALT-21112

- **Spec:** 1 x 1W Hi-Power aluminium resistant head light
With optical lens produce no halo effect
3 mode (high/low/flashing) , 3 x AAA batteries included
- **Size:** 104 mm
- **Weight:** 100g (w/o batteries)



ALT-21401

- **Spec:** Economic F+R light set
Front: 2 Mode with 3 LED & 3*AAA batteries
100hrs for run time
Rear: 4 Mode with 3 LED & 2*AAA batteries
130hrs for run time
- **Weight:** Front :65 g (w/ batteries)
Rear: 48 g (w/o batteries)



ALT-2505

- **Spec:** Plastic injection bracket
For front light fit to front fork bridge
- **Weight:** 30g



ALT-21201

- **Spec:** Hi-power white 3W LED head light
Zinc die-cast Body & cap with Cr-mo
2 mode and water resistant, heat-sink in AL6061
Illumination in 187M
With tool free nylon bracket, 3 x AAA batteries included
- **Weight:** 148g (including battery)



ALT-21304

- **Spec:** Hi-power head light
With 1W white LED 3 Mode
- **Weight:** 61g (w/o batteries, With bracket)



ALT-21402

- **Spec:** Economic F+R light set
Front: 2 Mode with 1 W LED & 3*AAA batteries
Rear: 4 Mode with 3 LED & 2*AAA batteries
- **Weight:** Front :50g (with batteries)
Rear: 67g (with batteries)



ALT-21110

- **Spec:** Classic 1 x 1W Hi-Power aluminium head light
2 mode, 3 x AAA batteries included
- **Size:** 100 mm
- **Weight:** 80 g (w/o batteries)



ALT-21111

- **Spec:** 1 x 1W Hi-Power aluminium head light
2 mode, 3 x AAA batteries included
- **Size:** 126 mm
- **Weight:** 80 g (w/o batteries)



ALT-21404

- **Spec:** 3 LED Head Light
3 Mode with tool free bracket
3*AAA battery
- **Size:** 90 x 35 x 35mm
- **Weight:** 103 g (with batteries & bracket)



ALT-21306

- **Spec:** Hi-power with 1W white LED head light
3 Mode, 3*AAA batteries
- **Weight:** 85g (w/o batteries, with bracket)



ALT-21308

- **Spec:** Economic F+R light set
Front: 2 Mode with 3 LED & 3*AAA batteries
Rear: 4 Mode with 3 LED & 2*AAA batteries
- **Weight:** Front :91 g (with batteries)
Rear: 67g (with batteries)



ALT-21307

- **Spec:** 4 LED tail light
4 Mode, 3*AAA batteries
- **Weight:** 74g (with batteries, with bracket)



ALT-21104

- **Spec:** 5 RED LED tail light
4 mode and water resistant (steady / flashing / random / chasing)
Wide lens design provides a better visibility
With bracket, 2 x AAA batteries included
- **Weight:** 66g (including batteries)
To replace ALT-2906



ALT-21309

- **Spec:** Hi-power white LED head light
Wide-angle illumination and USB charging design
3 mode and rainproof, illumination distance : 30M
With tool free nylon bracket, 4 x AA batteries included
High power mode: approx. 5hrs
City ECO mode: approx. 12 hrs
Flashing mode: approx. 35 hrs
- **Weight:** 174g (w/o batteries)

ALT-21309A -- 4 MITSUBISHI NI-MH batteries 1.2V/2500mAh inclusive, USB cable USB charger jack



ALT-2901

- **Spec:** Mini Safety headlight
3 x White brilliant LED
2 mode: constant and flash
QR designed resin bracket for tube dia 19-30mm
3 x R03 (AAA) batteries required
- **Size:** 76.5 x 32 mm
- **Weight:** 47g (75g w/batteries)



ALT-21303

- **Spec:** Slight 2 *0.5W LED Light
3 Mode with tool free bracket
- **Option:** White LED - front , Red LED - rear
Lamp case color: Black or White
- **Size:** 72 x 32.5 x 36mm
- **Weight:** 35 g (w/o batteries)



ALT-21109

- **Spec:** 1 Hi-Power 0.5w red or yellow LED tail light
With 2 red LED
3 mode, 1 Top View and Double side view
- **Weight:** 66g (w/batteries and bracket)



ALT-21405

- **Spec:** Ultra bright 2 LEDs 360° visibility Light
100Hours Running Time
ø10mm~ø32mm adjustable & tight
2 colors LED double view with 2 mode
2*CR2032, 1*elastic strap including
- **Size:** 26 x 60 x 23mm
- **Weight:** 34g (with battery)

ALT-21406F: 4 White LED for front only
ALT-21406R: 4 Red LED for rear only



ALT-21403

- **Spec:** Water resistance mini light with 1 LED
Silicone strap tie to handlebar
2 Mode, CR2032 batteries
More Than 85hrs for run time
- **Option:** White LED - front, Red LED - rear
- **Size:** 125 x 26.5 x 22.5mm
- **Weight:** 10g (w/o batteries)



ALT-21302

- Spec:** Water resistance mini light with 2 LED
Silicone strap tie to handlebar
2 Mode, CR2032 batteries
More Than 100hrs for run time
- Option:** White LED - front, Red LED - rear
- Lamp case color:** White, Black, Green, Yellow, Blue, Red
- Size:** 38 x 28 x 18mm
- Weight:** 14 g (w/o batteries)



ALT-21305

- Spec:** 2 mode Safety mini light with 1 LED
Silicone strap tie to handlebar
CR2032 batteries F+R / set
White LED for front & Red LED for rear
- Lamp case color:** White, Black, Pink, Transparent
- Size:** 38 x 27 x 15mm
- Weight:** 22 g (with batteries)



ALT-21202

- Spec:** Safety mini light with 3 LED
Silicone strap tie to handlebar
CR2032 batteries
- Option:** White LED - front, Red LED - rear
- Lamp case color:** White, Black, Green, Yellow, Purple, Blue, Red
- Size:** 46 x 35 x 12mm
- Weight:** 20 g (with batteries)

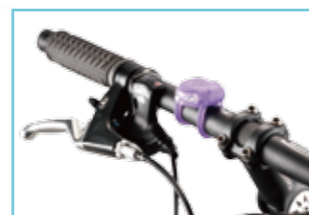

ALT-2910

- Spec:** Safety mini light
Muose shape with 3 LED
Elastic strap tie to handlebar
 - Option:** White - front (2 x CR2032 button batteries required)
Red - rear (1 x CR2032 button batteries required)
 - Size:** 30 x 50 x 15 mm
 - Weight:** 10g
- To replace ALT-2701**



ALT-21301

- Spec:** Clasp 2 LED Light 3 Mode
- Option:** White or Red LED
- Weight:** 10 g / pc (with batteries)



ACL-21205

- Spec:** 4-DIGIT Adjustable cable lock
- Size:** 10 x 1500mm
- Weight:** 612g



ACL-2901

- Spec:** Resettable 4-digit wire lock
Senso-Sparkling cable
- Size:** 10 x 1200mm
- Weight:** 438g



ACL-2907

- Spec:** 4-digit cable lock
- Size:** 8 x 1500mm
- Weight:** 320g



ACL-2905

- Spec:** Cable lock with keys
- Size:** 8 x 1500mm
- Weight:** 265g



ACL-21201

- Spec:** Cable lock
ABS protection body covered
Included 2 R keys and bracket
- Size:** 10 x 1850mm
- Weight:** 673g



ACL-21204

- Spec:** Integrated cable lock
with carrying bracket
With 2 keys
- Size:** 8 or 10 x 1500mm
- Weight:** 386g



ACL-21003

- **Spec:** Mini Reflect Cable with 3-digit lock
- **Size:** 4 x 2500mm



ACL-2504

- **Spec:** 4-digit wire lock
Code resettable with resin frame bracket
- **Size:** 10 x 1800mm
- **Weight:** 668g



ACL-21203

- **Spec:** Small but strong folding lock
Heated steel with plastic cover
With 2 keys and nylon bag
- **Size:** 690mm
- **Weight:** 812g



ACL-21202

- **Spec:** 3-DIGIT Cable lock
- **Size:** 3 x 1500mm
- **Weight:** 89g



ACL-21001

- **Spec:** Cable lock with bracket & keys
- **Size:** 8 x 1500mm
- **Weight:** 434g



AOS-2703

- **Spec:** Nylon double lock zip tie
With release lever
10PCS / SET
- **Size:** 225mm
- **Weight:** 1.5g / pc



AOS-2602

- **Spec:** Replace zip tie for good looking on disc brake bikes
Floating design top holder for suspension movement
Fix lower holder keep position on blade
Weather resistant EPDM O-ring
4mm hex key and wrench included
- **Weight:** 28g



AOS-21302

- **Spec:** Alloy adapter for vale cap
- **Size:** For schrader to Presta
- **Weight:** 5g / pr



AOS-21301

- **Spec:** Alloy Schrader valve cap
- **Size:** Smile Cylinder, Wine Bottle, Peach, Bullet
- **Weight:** 5g~10g / pr



AOS-21203

- **Spec:** Valve cap
- **Size:** suitable for both Presta and Schrader valve
- **Weight:** 3.5g / pr
To replace AOS-2701



AOS-2904

- **Spec:** Schrader valve cap
- **Size:** Football or Baseball looking
- **Weight:** 8g / pr



AOS-2801

- **Spec:** Anodized Resin valve caps
- **Size:** American (Schrader) type
- **Option:** Flower, Bear, Skull, Smile, Clown
- **Weight:** 5g to 10g / pr



AOS-21201

- **Spec:** Chain stay protector--PU
- **Size:** 260 x 90 / 110mm
- **Weight:** 24g / pc



AOS-21401

- **Spec:** TPR Chain stay protector
- **Size:** 220mm
- **Weight:** 8g / pc



AOS-21202

- **Spec:** Chain stay protector--PU with Neoprene Filament design
- **Size:** 260 x 90 / 110mm
- **Weight:** 28g / pc



AOS-2901

- **Spec:** Chain stay protector
Semi-Carbon fabric 3M sticker backing
 - **Size:** 260mm
 - **Weight:** 3g / pc
- AOS-2902 -- Kevlar fabric



AOS-21204

- **Spec:** Chain stay protector
With silicone slipless back and anti-revolve
- **Size:** 260 x 90 / 110mm
- **Weight:** 22g / pc



AOS-21002

- **Spec:** Chain stay protector
With slipless back and velcro
- **Size:** 260 x 80 / 95mm
- **Weight:** 19g / pc



AOS-2601

- **Spec:** Neoprene CHAIN embossed chain stay protector
With slipless back and velcro
- **Size:** 105 / 90 x250mm
- **Weight:** 20g / pc



AMP-21401

- **Spec:** High polish Alloy Floor pump with 2.5" gauge
Alloy handle and barrel
With clever twin valve
Max. pressure 240psi
- **Size:** 640mm
- **Weight:** 1210g



AMP-21402

- **Spec:** Alloy Floor pump with 2" gauge
Wood handle and alloy barrel
Big triangle Nylon base with alloy plates
Dual head fits Presta & Schrader
Max. pressure 160psi
- **Size:** 700mm
- **Weight:** 1600g



AMP-21403

- **Spec:** High polish Alloy Floor pump with 3" gauge
Alloy handle and barrel
Auto Switching dual head fits Presta & Schrader
Max. pressure 240psi
- **Size:** 640mm
- **Weight:** 1380g



AMP-21205

- **Spec:** Alloy Floor pump with gauge
Ball needle set stored in base
Dual head for Presta & Schrader
Max. pressure 140psi
- **Size:** 560mm
- **Weight:** 770g



AMP-21201

- **Spec:** High pressure floor pump
Fluency and strong base, Steel barrel
2" gauge easy to reading
Rotating gauge cover and reversible Presta and Schrader
Max. pressure 160psi
- **Size:** 620mm
- **Weight:** 1462g



AMP-21101

- **Spec:** 26" High pressure floor pump
Wooden handle, aluminum barrel & base
Including 2-non-slip bracket
With Twist and lock twin head
Max. pressure 180psi
- **Size:** 635mm
- **Weight:** 1146g



AMP-2602

- **Spec:** Floor pump resin barrel
AL air-flow tube comfort rubber handle
With mid mounted gauge clever valve
- **Size:** 605mm
- **Weight:** 798g



AMP-2401

- **Spec:** Floor pump clever valve
AL barrel plastic base
With gauge high Pressure
Max volume 160psi
- **Size:** 600mm
- **Weight:** 854g



AMP-21203

- **Spec:** Frame-Fit mini pump
2-tone T-handle
With Alum 6063 barrel
Reversible Presta and Schrader
- **Size:** S, M, L, XL
- **Weight:** 226g-M



AMP-21305

- **Spec:** 1 way alloy barrel CNC mini pump
Dual head for Presta & Schrader
5" retractable hose design
Max. pressure 120 psi
- **Size:** 210mm
- **Weight:** 95g



AMP-2706

- **Spec:** Durable Nylon fiber made mini pump
Twin head for Presta & Schrader
2-Tone comfort grip
Max. pressure 80psi(5.5bar)
- **Size:** 240mm
- **Weight:** 112g



AMP-601

- **Spec:** Super Mini one-way pump
Reversible valve for Schrader and Presta
With lock lever
- **Size:** 258mm
- **Weight:** 118g



AMP-21304

- **Spec:** 2 stage alloy mini pump
1" rotatable Gauge,
High pressure / big volume switch
Alloy outer and plastic inner barrel
Auto head for Presta & Schrader
Max. pressure 120 psi
- **Size:** 215mm
- **Weight:** 160g



AMP-21202

- **Spec:** Plastic mini pump
2-tone soft T-handle
With Alum Sleeve and Precise in-line gauge
Reversible Presta and Schrader
- **Size:** 225mm
- **Weight:** 160g



AMP-2603

- **Spec:** Mini pump AL barrel
Comfort D2 handle with gauge
Clever valve for Schrader and Presta
- **Size:** 245mm
- **Weight:** 184g



AMP-2103

- **Spec:** Telescope design with gauge
Twin-head valve for Presta and Schrader
Ergonomic T-handle
- **Size:** 245mm
- **Weight:** 178g



AMP-21301

- **Spec:** 1" Gauge CNC mini floor pump
Safety Pinch-Free locked T-handle
High pressure / big volume switch
Dual head for Presta & Schrader
- **Size:** 300mm
- **Weight:** 217g



AMP-21001

- **Spec:** AL6063 barrel mini floor pump
2-tone comfort I type press bar
Prestis in-line gauge
Max. pressure 140psi
Foldable hose with smart valve
- **Size:** 280mm
- **Weight:** 178g

To replace AMP-2301& AMP-2702



AMP-21102

- **Spec:** Big volume micro floor pump
2-tone comfort L type press bar
Extra-longer hose storage tube
Reversible for Presta and Schrader
Max. pressure 120psi with big volume
- **Size:** 295mm
- **Weight:** 182g



AMP-21303

- **Spec:** Alloy CNC mini floor pump
Safety Pinch-Free locked T-handle
High pressure / big volume switch
Smart head for Presta & Schrader
- **Size:** 305mm
- **Weight:** 135g



AMP-21002

- **Spec:** Hose nested alloy barrel mini floor pump
foldable metal pedestal
RVS head for Presta & Schrader
Max. pressure 100PSI
- **Size:** 340mm
- **Weight:** 209g

AMP-21103

- **Spec:** High Pressure 2-way Mini pump
AL6063 barrel with 2-tone comfort T-handle
Thumb-lock lever
Reversible for Presta and Schrader
Max. pressure 120psi
- **Size:** 240mm
- **Weight:** 84g



AMP-21302

- **Spec:** Alloy shock pump with 1.5" gauge
Safety Pinch-Free locked T-handle
Swivel hose for easy pumping
2-stage non-leakage valve
Max. pressure 400psi
- **Size:** 263mm
- **Weight:** 150g



AMP-2703

- **Spec:** Compact shock pump
2-tone comfort grip and foldable hose
Removable gauge 300 or 100psi
2-3psi micro adjust button
Max. pressure 300psi (20.8bar)
- **Size:** 230mm
- **Weight:** 208g

To replace AMP-2405



AMP-2704

- **Spec:** Pump clip for EV (English Valve) tube
Nylon fiber with chainring
- **Weight:** 17g



AMP-2406

- **Spec:** Clever valve for floor pump
- **Weight:** 64g



ARD-2601

- **Spec:** CNC Alloy RD protector
Protects original RD hanger
- **Weight:** 70g



ARO-21201

- **Spec:** Super light RD pulley AL7075 flange
2-pc bushing with industrial Japanese bearing
- **Size:** 10T or 11T
- **Weight:** 12g / pr



ARO-2901

- **Spec:** Super Ceramic bearing constructed pulley
- **Fittings:** A- Shimano 8, 9 & 10SPD
B- Shimano 7 & Campagnolo 8 SPD
C- Campagnolo 9 & 10 SPD
D- Sram 9.0 (97/98'), 9.0SL (98'), 7.0 (97/98/99')
- **Size:** 11T
- **Weight:** 22g / pr



ARO-21101

- **Spec:** Light RD pulley Alloy7075 flange
2-pc bushing with industrial Japanese bearing
- **Size:** 11T
- **Weight:** 16g / 2pr

ARO-601

- **Spec:** RD pulley Alloy flange
With industrial bearing
Shimano compatible 2pc-set
 - **Size:** 10T with fitting for 7 or 8SPD
 - **Weight:** 27g / pr
- ARO-2501 -- 11T**



AGS-21301

- **Spec:** PC/Nylon frame with 1-pc design
400% UV protection
Frame within non-slip design
- **Frame:** White / Red
- **Option lens:** Transparent, Smoke, Orange,
Yellow, Blue, Multi-Coated
- **Weight:** 30g



AGS-21303

- **Spec:** PC/Nylon frame with 1-pc design
400% UV protection
Frame within non-slip design
- **Frame:** Black / Red, ALL Black
- **Option lens:** Transparent, Smoke, Orange,
Yellow, Blue, Multi-Coated
- **Weight:** 29g



AGS-21304

- **Spec:** PC/Nylon frame with 1-pc design
400% UV protection
Frame within non-slip design
- **Frame:** Black, White, Red
- **Option lens:** Transparent, Smoke, Orange,
Yellow, Blue, Multi-Coated
- **Weight:** 23g



AGS-21302

- **Spec:** PC/Nylon frame with 2-pc design
400% UV protection
Frame within non-slip design
- **Frame:** Black / Silver or Black / Gold
- **Option lens:** Transparent, Smoke, Orange,
Yellow, Blue, Multi-Coated
- **Weight:** 38g



AGS-21201

- **Spec:** PC/Nylon frame with 2-pc design
400% UV protection
Frame within non-slip design
- **Frame:** Black or White
- **Option lens:** Transparent, Smoke, Orange,
Yellow, Blue, Multi-Coated
- **Weight:** 44g



AGS-21202

- **Spec:** PC/Nylon frame with 2-pc design
400% UV protection
Frame within non-slip design
- **Frame:** Black or White
- **Option lens:** Transparent, Smoke, Orange,
Yellow, Blue, Multi-Coated
- **Weight:** 44g



AGS-21101

- **Spec:** PC/Nylon frame with 2-pc design
400% UV protection
- **Frame:** BK / Red, BK/Blue
- **Option lens:** Transparent, Smoke, Orange,
Yellow, Blue, Multi-Coated
- **Weight:** 24g



AGS-21001

- **Spec:** PC / Nylon frame
Cool looking design
400% UV protection
- **Frame:** Gold / WHT, Blue / WHT
- **Option lens:** Orange, Brown or smoke
- **Weight:** 28g



AGS-21003

- **Spec:** PC / Nylon frame
Sporty looking design
400% UV protection
- **Frame:** BK / Orange
- **Option lens:** Orange, Brown or smoke
- **Weight:** 24g



AGS-2901

- **Spec:** PC / Nylon frame
Comfortable nose guard
Slipless Kraton holders
100% UV protection 1-PC replaceable lens
- **Frame:** Red
- **Option lens:** Orange, Brown or smoke
- **Weight:** 27g



AGS-2902

- **Spec:** PC / Nylon frame
Comfortable nose guard
Hollowed holders with slipless Kraton ends
100% UV protection 2-PC replaceable lens
- **Frame:** Grey or Black
- **Option lens:** Orange, Brown or smoke
- **Weight:** 24g



AGS-2805

- **Spec:** PC / Nylon 2-frame design
Detachable interior frame
1-pc lens air-flew design
100% UV protection
- **Frame:** Black or Silver
- **Option lens:** Transparent, Smoke,
Mirror black, Brown, Yellow or Blue
- **Weight:** 30g



AGV-2802

- **Spec:** Comfort and luxury half-finger design
Reinforcement patches
GEL palm for shock absorbing
- **Size:** XS, S, M, L, XL
- **Weight:** 40g / pr



AWR-2905

- **Spec:** SHOE cover
Lyca fabric
- **Size:** S- 38-41
M- 42-45
L- 46-49
- **Weight:** 56g / pr



AWR-2907

- **Spec:** SHOE cover
Lyca back water resistant
Warmer backing inner
- **Weight:** 90g / pr



AWR-2901

- **Spec:** ARM WARMER
Lyca fabric
- **Size:** S-115 x 65 x 405mm
M-130 x 70 x 450mm
L-135 x 75 x 470mm
XL-140 x 75 x 490mm
- **Weight:** 43g / pr / S

AWR-2902 -- Lyca fabric with warmer backing inner



AWR-2903

- **Spec:** LEG WARMER
Lyca fabric
- **Size:** S-180 x 80 x 530mm
M-190 x 90 x 580mm
L-210 x 95 x 640mm
XL-210 x 95 x 680mm
- **Weight:** 100g / pr / L

AWR-2904 -- Lyca fabric with warmer backing inner



AWR-2908

- **Spec:** SHOE cover
Water and wind proof
Neoprene with Lyca fabric
Zipper with safety reflector
- **Weight:** 162g / pr



AHT-21401

- **Spec:** Full In- Mold PC shell with EPS helmet
19 vents, embedded LED with 360° optic fiber design ensures riding safety flashing for 120hrs, 2*AAA Rotary adjustment system with neck Retaining pad +/- 30mm adjustment.
- **Size:** 54-58cm for M
58-64cm for L
- **Weight:** 290g for M, 320g for L



AHT-21402

- **Spec:** Full In- Mold PC shell with EPS helmet
24 vents, embedded LED with 360° optic fiber design Ensures riding safety flashing for 120hrs, 2*AAA Rotary adjustment system with neck Retaining pad +/- 30mm adjustment.
- **Size:** 54-58cm for M
58-64cm for L
- **Weight:** 290g for M, 320g for L



ASE-21301

- **Spec:** MTB Sporty shoes for entry-level
- **Size:** 38~46
- **Weight:** 656g / pr



ASE-21302

- **Spec:** ROAD Sporty shoes for entry-level
- **Size:** 38~46
- **Weight:** 628g / pr



ASE-21401

- **Spec:** MTB Sporty shoes
- **Size:** 38~46
- **Weight:** 670g / pr



ASE-21402

- **Spec:** ROAD Sporty shoes
- **Size:** 38~46
- **Weight:** 654g / pr



APD-ARC6

- **Spec:** Interchangeable rear Floating type cleats
KEO system pedals / shoes compatible
 - **Size:** Red for 7°
 - **Weight:** 108g / set
- APD-BLK6 -- black colors**



APD-KRC1

- **Spec:** KEO system floating type removable cleats
 - **Size:** 9°
 - **Weight:** 50g / set
- APD-KRC2 : 6°**
APD-KRC3: 0°



APD-BLK1

- **Spec:** Fix type cleats
Look system pedals/shoes compatible
- **Size:** 0°
- **Weight:** 50g / set

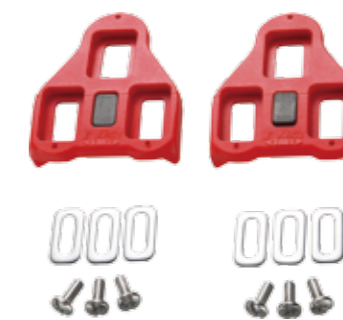

APD-ARC1

- **Spec:** Floating type cleats
Look system pedals/shoes compatible
- **Size:** 9°
- **Weight:** 50g / set



APS-21301

- **Spec:** Double Toe Strap for Fixed gear
- **Weight:** 86g / pr



APS-21302

- **Spec:** Double Toe Strap for Fixed gear
- **Weight:** 92g / pr



APS-21001

- **Spec:** Toe Strap
Leather with reinforced laminate
- **Size:** 13 x 430 mm
- **Weight:** 54g / pr



APS-401

- **Spec:** Webbing strap for toeclip
With fix buckle 2pc / pr
- **Weight:** 52g / pr



APC-21201

- **Spec:** Stainless Steel with EDC colors toe clip
- **Weight:** 74g / pr



APC-21202

- **Spec:** Stainless Steel with Painting colors toe clip
- **Weight:** 106g / pr



APC-2910

- **Spec:** Stainless Steel toe clip
- **Size:** L or M
- **Weight:** 46g / pr--M



APC-21203

- **Spec:** Stainless Steel with EDC colors toe clip
- **Weight:** 56g / pr



ATL-21302

- **Spec:** Multi-function Tool for press-fit BB
Install and remove bearing 6805, 6806,
Press-fit BB R92 / T86,
Converter for BB30 to BB24
- **Weight:** 1082g (W/BOX)



ATL-21101

- **Spec:** Multi-purpose tool kit
- **Size:** Nylon fiber tire lever 2pcs
Folding tool kit with 2 / 2.5 / 3 / 4 / 5 / 6mm allen key
Tire patch set, chain remover, spoke adjuster,
8 / 10 mm spanner
- **Weight:** 558g



ATL-2804

- **Spec:** Torque wrench range 2-24Nm
Easy adjust by grip-twist
- **Size:** With Allen keys: 3,4,5,6,8 & 10mm T25 torx
- **Weight:** 620g



ATL-2001

- **Spec:** Tool box 19-item-set
- **Size:** Adjustable BB cup tool
15 / 16 & 15 / 17 pedal wrench
Cartridge BB tool
6"adjustable forged steel wrench
3 steel & 3 nylon tire levers
BB& headset locking tool
Chain rivet extractor & assembler
M8 hex wrench for crank arm removal & 1/2" adapter
Inner tube repair kit
+/- screw driver
Freewheel remover
8 X 10mm open wrench
Sprocket wrench
30 / 32 / 36 / 40mm 4-in-1 headset wrench
13 / 14 / 15 / 16mm hub-cone wrenches
Cotterless crankarm extractor
7-groove spoke adjuster
2 / 2.3 / 3 / 4 / 5 / 6mm hex wrench set
- **Weight:** 2800g



ATL-2304

- **Spec:** 19-Function tool kit
2 / 2.5 / 3 / 4 / 5 / 6 / 8mm Allen key
8 / 9 / 10 / 12mm box wrench, knife
0.127 / 0.130 / 0.136" spoke wrench
+/- screw driver, tire lever, chain rivet extractor
- **Weight:** 206g



ATL-21304

- **Spec:** 16-Function mini full CNC flat pocket design tool kit
Spoke tool 14G/15G, Mavic M7 / M9
Hex key 2 / 2.5 / 3 / 4 / 5 / 6 / 8mm
#2 +/- screw driver,
T25 Torx, Chain too for 11SPD
- **Weight:** 140g



ATL-21112

- **Spec:** 17-Function tool kit with Mirror like
Spoke wench 14G/15G, 0.136", 0.156"
Hex key 2 / 2.5 / 3 / 4 / 5 / 6 / 8mm
#2 +/- screw driver
T25 Torx, Chain too for 9&10SPD, 8 / 1 0mm wrench
- **Weight:** 168g
- **To replace** ATL-2802



ATL-2901

- **Spec:** 15-Function tool kit
Spoke wrench 14G/15G, 0.136"
Hex key 2 / 2.5 / 3 / 4 / 5 / 6 / 8mm
#2 +/- screw driver
Knife, tire lever & 10mm wrench
- **Weight:** 119g
- **To replace** ATL-2709



ATL-21113

- **Spec:** Mini CNC 9-Function tool kit
CNC Hex key 2 / 2.5 / 3 / 4 / 5 / 6 / 8mm
T25 Torx, Phillips & flat screw driver
- **Weight:** 88g



ATL-21402

- **Spec:** 7-Function CNC semi-forged hex wrench set
2.5 / 3 / 4 / 5 / 6 hex keys & T25 wrench, philips wrench
- **Weight:** 65g
- **To replace** ATL-21207



ATL-21303

- **Spec:** 10-Function tool set
2 / 2.5 / 3 / 4 / 5 / 6 / 8 hex keys
T25 wrench, philips wrench, flat screwdriver
- **Weight:** 161g



ATL-21307

- **Spec:** 9-Function LONG ARM design tool set
2 / 2.5 / 3 / 4 / 5 / 6 / 8 hex keys
T25 wrench, flat screwdriver
- **Weight:** 126g
- **To replace** ATL-2902, ATL-2617



ATL-21401

- **Spec:** Bicycle Phone Holder
QR to mount on bike stem
Expandable design
- **Size:** 58~70mm
- **Weight:** 80g



ATL-2602

- **Spec:** Fluorescent trouser band
- **Weight:** 20g



ATL-21115

- **Spec:** Safe with Fluorescent band
With 4 LED
- **Weight:** 18g (with battery)



ATL-2405

- **Spec:** "+" spoke adjuster with magnet
- **Weight:** 47g



ATL-21202

- **Spec:** Alloy adjuster bolt
for frame derailleur and brake cable
- **Size:** M5*18mm, 2pcs / set
- **Weight:** 6g / set



ATL-2603

- **Spec:** Trouser band ABS injection
With 3M reflector
- **Weight:** 18g



ATL-21114

- **Spec:** AL Spoke wrench
0.127", 0.130", 0.136"
3pc / set
- **Weight:** 20g



ATL-21203

- **Spec:** Alloy cable hanger for canti brake
With cable wire and cable end
- **Weight:** 20g / set



ATL-21204

- **Spec:** Crank bolt with ED colors
- **Size:** M8 x P 0.75 x 8.5mm
4pcs-set or 5pcs-set
- **Weight:** 6g / set -- 4pcs



ATL-21205

- **Spec:** 10pcs Tire patch kit
- **Size:** 2*24 X 35mm oval rubber patch,
4*25mm round tube patch,
2*2cm valve tubing, 1*7cc rubber cement
1*round metal buffer
- **Weight:** 26g within 10*12cm box



ATL-2505

- **Spec:** Nylon fiber tire lever
3pc-set
- **Weight:** 39g



ATL-2611

- **Spec:** Nylon body with bristles scrub brush
For Derrailleur, chain or any parts where get dirt
- **Weight:** 31g



ATL-21206

- **Spec:** 10pcs Tire patch kit
- **Size:** 2* nylon tire lever, 6* 25mm glueless patch ,
1*4cm marking pen , 1* 3 x 7cm sand paper.
- **Weight:** 40g within 10*15cm box



ATL-2701

- **Spec:** Pre-Glued tire patch kit
- **Size:** 12 x 25mm round patches with 1 sand paper
- **Weight:** 6g / set



ATL-2612

- **Spec:** DIY chain cleaner with plastic outer case
4-sided scrub brushes inside
- **Weight:** 267g



ATL-21306

- **Spec:** Tool can with hanger
 - **Size:** 135mm for M
190mm for L
 - **Weight:** 48g--M, 60g--L
- To replace ATL-2618/ATL-2619



ATL-21107

- **Spec:** Bleeding Kit
Suitable for all hydraulic dis systems
Magura, Hayes, Avid, Hope, Formula.
Injection, transparent tube and components
- **Size:** 190 x 133 x 65mm
- **Weight:** 383g



ATL-21305

- **Spec:** Steel core tire lever
3pc / set
- **Weight:** 97g / set



ATL-2803

- **Spec:** Chain wearker indicator
CNC steel
1% not to go
0.75% to go
- **Size:** 140x48mm
- **Weight:** 36g



ATL-2702

- **Spec:** Chain extractor upgraded design
A stainless chain holder added
 - **Weight:** 89g
- To replace ATL-2601



ATL-21103

- **Spec:** Bottom Bracket Wrench tool
Stainless steel
- **Size:** 240mm
- **Weight:** 402g



ATL-2713

- **Spec:** Crank tool for Shimano Hollowtech 2
- **Size:** 252mm
- **Weight:** 242g



ATL-2715

- **Spec:** Crank tool for Octalink
- **Size:** 234mm
- **Weight:** 283g



ATL-2608

- **Spec:** 3-in-1 Y type socket
- **Size:** 8 / 9 / 10mm
- **Weight:** 82g



ATL-2710

- **Spec:** Ergonomic T-bar Torx wrench
Hardened Cr-Mo
- **Size:** #25 x L100mm
- **Weight:** 32g



ATL-2714

- **Spec:** Freewheel remover for Campagnolo
- **Size:** 234mm
- **Weight:** 228g



ATL-2607

- **Spec:** 3-in-1 Y type hex wrench
- **Size:** 4 / 5 / 6mm
- **Weight:** 70g



ATL-2609

- **Spec:** Nut wrench one side for chaining
and another side for self-extracted crank cover
- **Size:** 100mm
- **Weight:** 20g



ATL-2610

- **Spec:** Freewheel turner with chain whip
- **Size:** 290mm
- **Weight:** 276g



ATL-2614

- **Spec:** Freewheel remover for Shimano HG cassette
- **Size:** 234mm
- **Weight:** 228g



ATL-2621

- **Spec:** L type 9-PC Hex wrench set
- **Size:** 1.5 / 2 / 2.5 / 3 / 4 / 5 / 6 / 8 / 10mm with holder
- **Weight:** 323g

ATL-2621C -- with colorful design



ATL-2711

- **Spec:** Cable cutter
with needle to fix/re-shape cable whole
- **Weight:** 157g



ATL-2613

- **Spec:** 15mm open wrench for pedal axle
- **Size:** 234mm
- **Weight:** 183g



ATL-2620

- **Spec:** ISIS drive cartridge BB tool
Shimano available
- **Size:** 242mm
- **Weight:** 307g

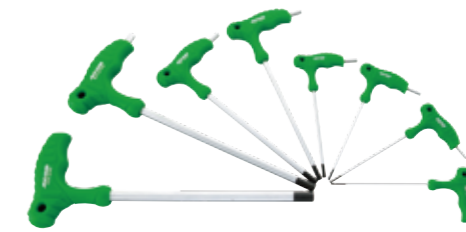

ATL-2510

- **Spec:** 2-way 8-PC Hex wrench set with stand
- **Size:** 2 / 2.5 / 3 / 4 / 5 / 6 / 8 / 10mm with display stand
- **Weight:** 1062g

ATL-2501A--2mm ATL-2510E--5mm
ATL-2510B--2.5mm ATL-2510F--6mm
ATL-2510C--3mm ATL-2510G--8mm
ATL-2510D--4mm ATL-2510H--10mm



ATL-2712

- **Spec:** Disc rotor tuning tool
- **Weight:** 223g



ATL-2604

- **Spec:** 8 x 200mm L type Hex wrench
With grip
- **Weight:** 111g



ATL-21108

- **Spec:** Rust proof penetrating oil
Protect metal parts from rust and corrosion
Displaces moisture from any surface
- **Size:** 600ml



ACOR BANNER

- **Spec:** Canvas all weather Red / Black / White oblong banner
- **Size:** 900 x 215mm
1500 x 430mm
2400 x 690mm



ATL-21109

- **Spec:** Brake & Parts cleaner
Removes brake fluid, oil and brake dust instantly
Fast-drying and w/o CFC
Using directly on pad, linings, and other friction parts design
- **Size:** 600ml



ATL-21110

- **Spec:** OMC2 racing chain lube
Not easily attract grit and grime
Prevent rust, wear and resist water wash-off
Heat resistance, low friction leads to long protection
- **Size:** 300ml



ACOR DECAL

- **Spec:** Red / Black decal
- **Size:** 28 x 24 cm for cars' wall or doors in light color
50 x 16 cm for inside windows or glasses



ACOR WIRSLET

- **Spec:** Nylon and cotton wristlet
- **Size:** 80 x 85mm, 1pr / set
- **Option:** White or Blue



ATL-21111

- **Spec:** Express Chain Degreaser
Quick and Effective dissolve stubborn grease, dirt, residue
Safe to clean parts, o-rings, seals and painted surfaces
- **Size:** 600ml



ATW-2401

- **Spec:** Adjustable stay for 12"-20" bikes
PP 5" wheel and rim
UPC coated Steel stays
- **Size:** 652g

ACOR DISPLAY STAND

- **Spec:** DIY Steel display stand painted
Black & Silver with ACOR logo
With 40pcs 25cm hangers
- **Size:** 2100 x 90 x 48 cm





AUSTRIA

BBF BIKE GmbH

- TEL: 49 3342 354360
- FAX: 49 3342 354333
- <http://www.bbf-bike.de>
- E-Mail: info@bbf-bike.de



BELGIUM

Bike Trading NV

- TEL: 32 57 487500
- FAX: 32 57 487501
- <http://www.acorsport.com>
- E-Mail: info@formula-cycling.be



COLOMBIA

Internacional De Comercio Libar Ltda

- TEL: 571 4118 530
- FAX: 571 4117 758
- E-Mail: libarltlda@hotmail.com



CROATIA

Marko-Projekt

- TEL: 385 1 4618 777
- FAX: 385 1 4616 592
- <http://www.markoprojekt.com>
- E-Mail: zdravko.bukarica@zg.htnet.hr



CZECH REPUBLIC

Velo C.Z.

- TEL: 420 495 271 379
- FAX: 420 495 269 198
- <http://www.wheeler.cz>
- E-Mail: info@wheeler.cz



DENMARK

PYTHON PRO APS

- TEL: 45 7011 1111
- FAX: 45 7011 1108
- E-Mail: ln@cobra.dk



GERMANY

BBF BIKE GmbH

- TEL: 49 3342 354360
- FAX: 49 3342 354333
- <http://www.bbf-bike.de>
- E-Mail: info@bbf-bike.de



HOLLAND

Bike Trading NV

- TEL: 32 57 487500
- FAX: 32 57 487501
- <http://www.acorsport.com>
- E-Mail: info@formula-cycling.be



HONG KONG

SUN HOP CYCLE CO.

- TEL: 852 23966581
- FAX: 852 7898182
- <http://www.sunhop.com>
- E-Mail: sunhop@biznetvigator.com



HUNGARY

J. P. Mali

- TEL: 36 1 420 5032
- FAX: 36 1 420 5321
- <http://www.mali.hu>
- E-Mail: mali@mali.hu



ITALY

BBF BIKE GmbH

- TEL: 49 3342 354360
- FAX: 49 3342 354333
- <http://www.bbf-bike.de>
- E-Mail: info@bbf-bike.de

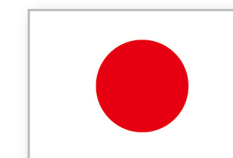

JAPAN

Action Sports

- TEL: 81 48 2587811
- FAX: 81 48 2587813
- <http://www.actionsports.co.jp>
- E-Mail: acor@actionsports.co.jp



KOREA

SAMHWA TELECOM IND. CO, LTD.

- TEL: 82 2 2109 1019
- FAX: 82 2 2109 1098
- <http://shsports.co.kr>
- E-Mail: samhwabike@gmail.com



LUXEMBURG

Bike Trading NV

- TEL: 32 57 487500
- FAX: 32 57 487501
- <http://www.acorsport.com>
- E-Mail: info@formula-cycling.be



NORWAY

Tempo AS

- TEL: 47 69 10 05 70
- FAX: 47 69 16 62 52
- <http://www.tempoas.no>
- E-Mail: post@tempoas.no



POLAND

BBF BIKE GmbH

- TEL: 49 3342 354360
- FAX: 49 3342 354333
- <http://www.bbf-bike.de>
- E-Mail: info@bbf-bike.de



ROMANIA

J. P. Mali

- TEL: 36 1 420 5032
- FAX: 36 1 420 5321
- <http://www.mali.hu>
- E-Mail: mali@mali.hu



SLOVAKIA

AGF Invest, s.r.o.

- TEL: 421 2 62 85 95 49
- FAX: 421 2 62 85 90 52
- <http://www.agfinvest.sk>
- E-Mail: solomonsgift@mweb.co.za



THAILAND

Asia International

- TEL: 662 887 7813
- FAX: 662 448 3150
- <http://www.asiabike.com>
- E-Mail: seema1@ksc.th.com



U.K.

Greyville

- TEL: 44 1 543 251328
- FAX: 44 1 543 256260
- <http://www.greyville.com>
- E-Mail: sales@greyville.com

